

Application No. 7192
 Permit No. 4228
 T.P.I.S. 41474

RECEIVED
 APR 10 1920

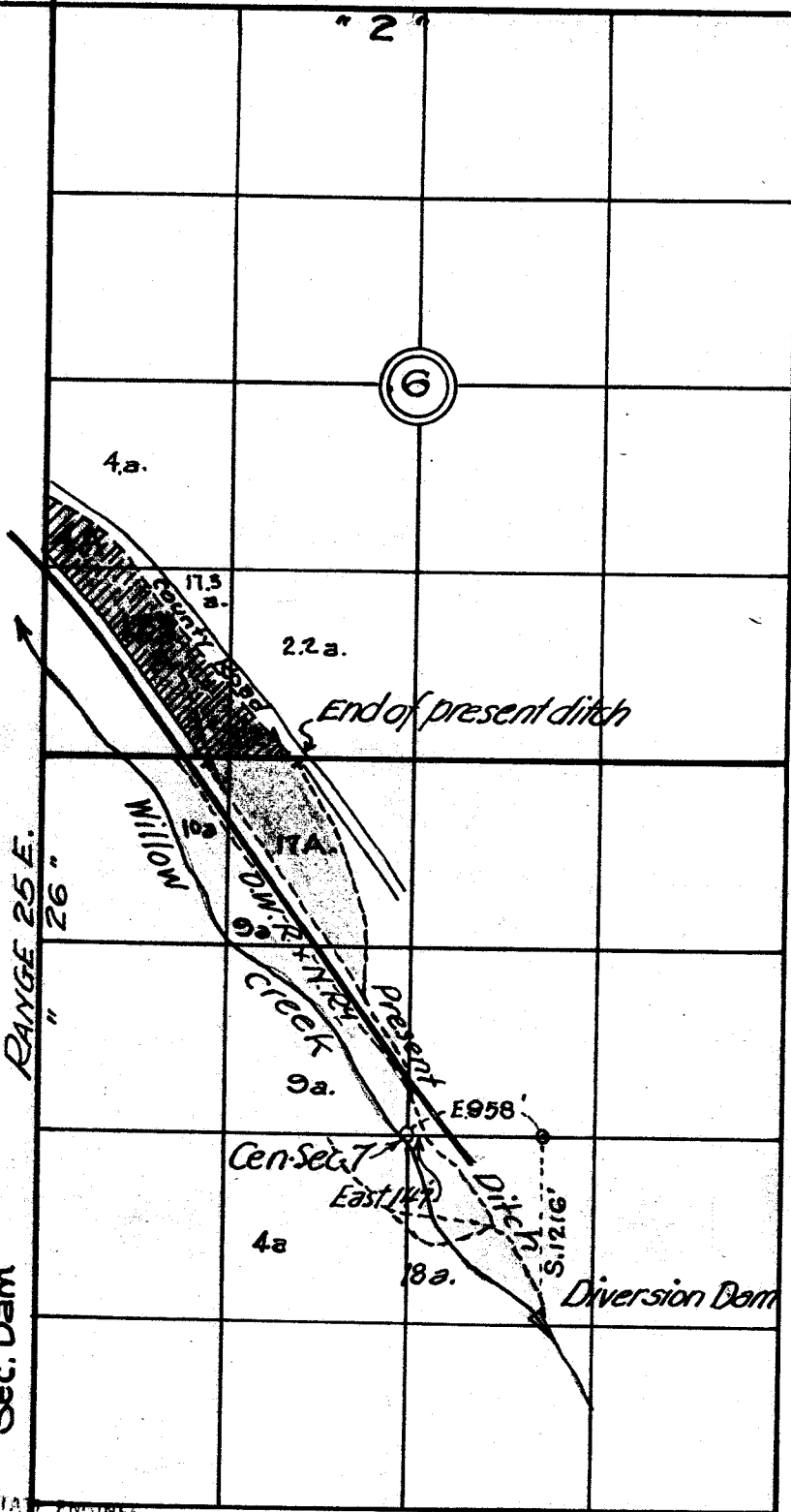
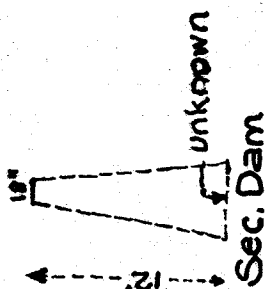
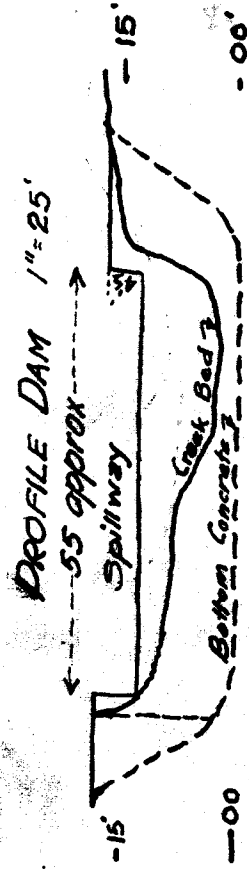

RANGE 25 E.

MAP
 Accompanying Application
 For Permit #
 scale 4" = 1 mi.

I, Clarence Hickey, of Heppner, Ore., do hereby certify that this map was made by me from notes taken during an actual survey made by me on Mar. 27, 1920, and that it correctly represents the works described in the accompanying application, together with the location of streams and other ditches in the immediate vicinity. Clarence Hickey, Surveyor.

OFFICE OF STATE ENGINEER

APR 10 1920

J. D. S.