

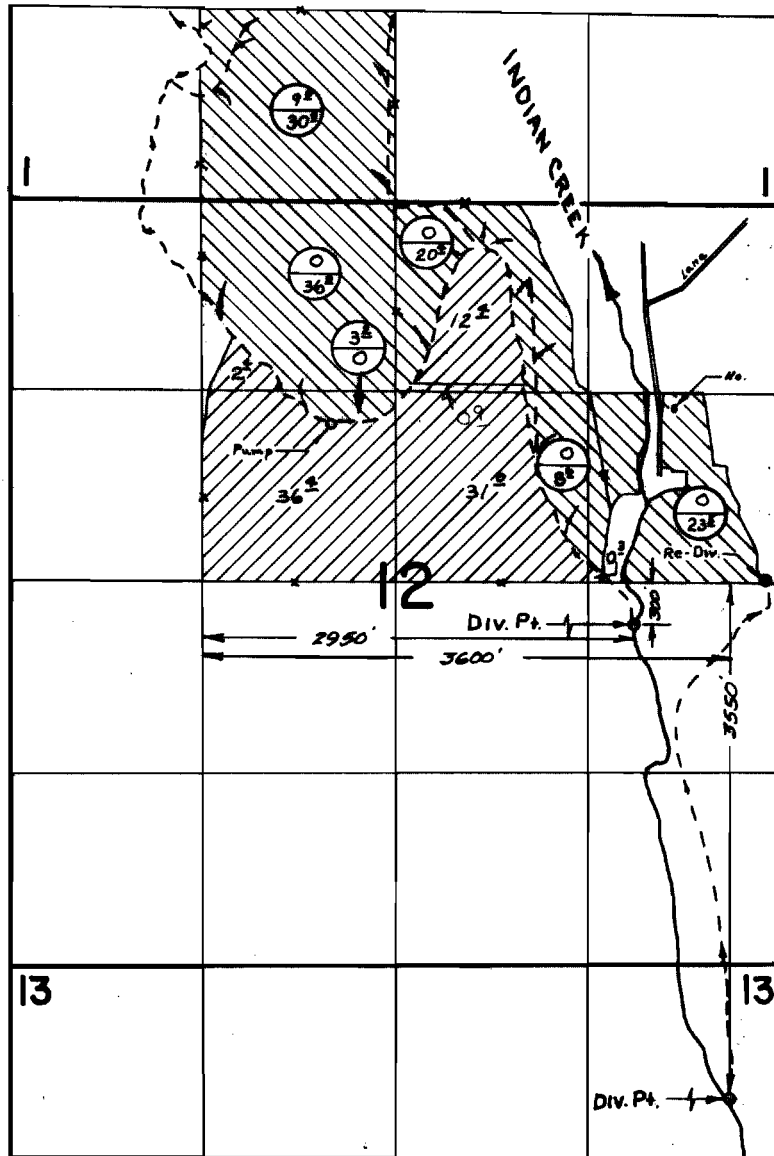

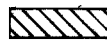

T.1S. R.39E. W.M.



DIV. PTS. LOC: 300'S. & 2950'E; 3550'S & 3600'E, BOTH FROM S.W. COR. SE & NW 1/4 SEC 12

 - Permit 30529
 - Permit 33249

 - Primary
 - Supplemental

FINAL PROOF SURVEY UNDER

Application No. 40858 Permit No. 30529
44453 Permit No. 33249
 IN NAME OF

Earl & Necha Torbell

Surveyed JULY 13, 1973, by R. G. MUCKEN