

T.3S. R.7E. W.M.

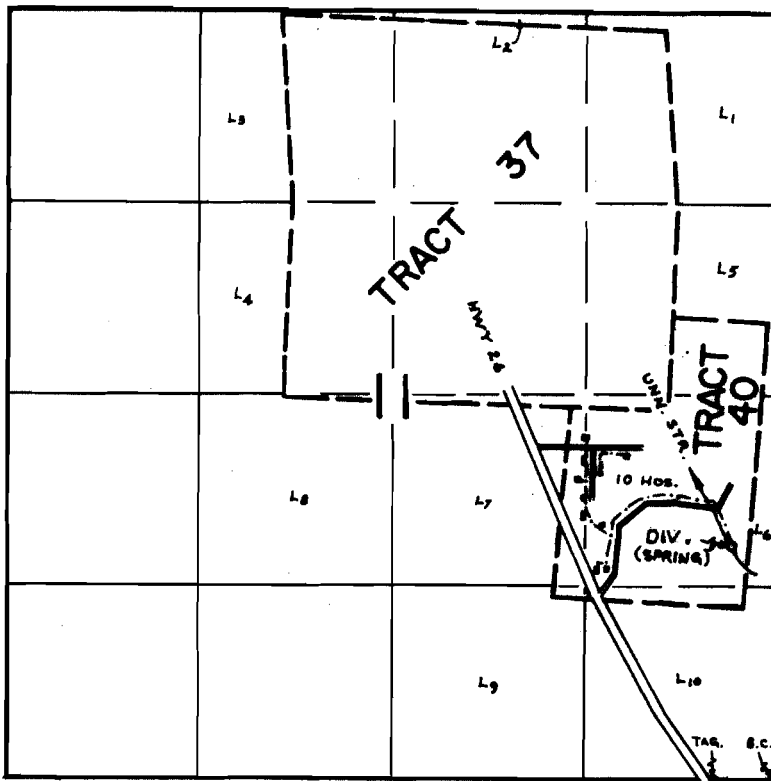

DIV.(Spring) Loc: 1600' N. & 310' W. From SE. cor. sec. 11

**FINAL PROOF SURVEY
UNDER**

Application No. 41580 Permit No. 32603
IN NAME OF

JOHN H. & I. ISABEL LAKE

Surveyed SEPT. 13, 1973, by R. MUCKEN