

# T. 25 S. R. 7 W. W.M.

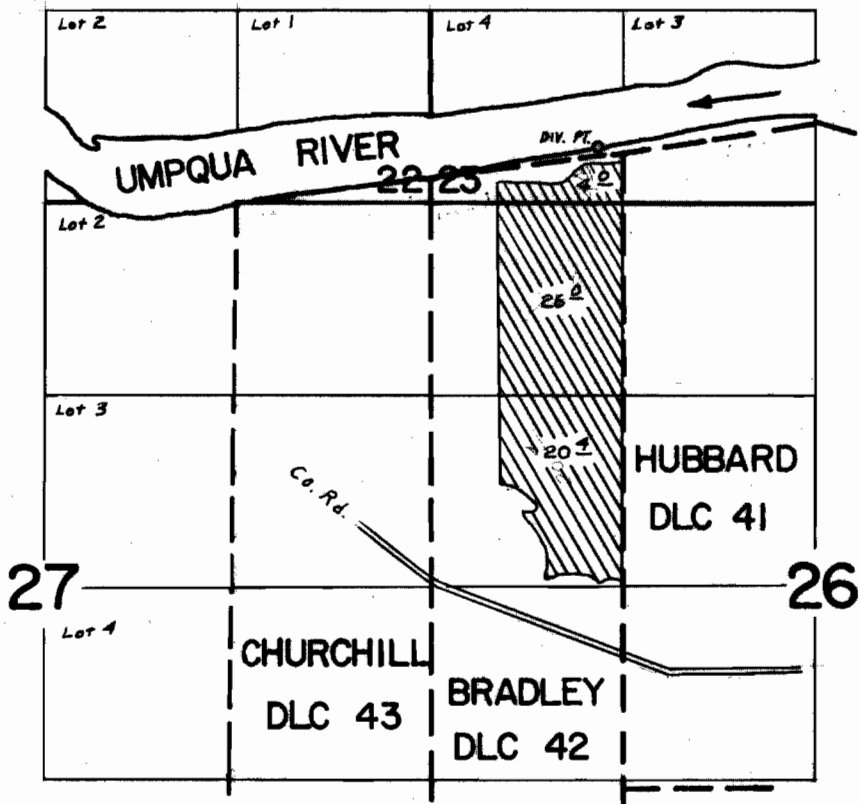

DIV. PT. LOCATED 4400 FT. N. Y 180 FT. W. From SW Cor. Hubbard DLC 41

## FINAL PROOF SURVEY UNDER

Application No. 47052 Permit No. 35192  
IN NAME OF

RAY E. DOERNER & PATRICIA M. DOERNER

Surveyed APR 5 1973, by L.E. GOULD