

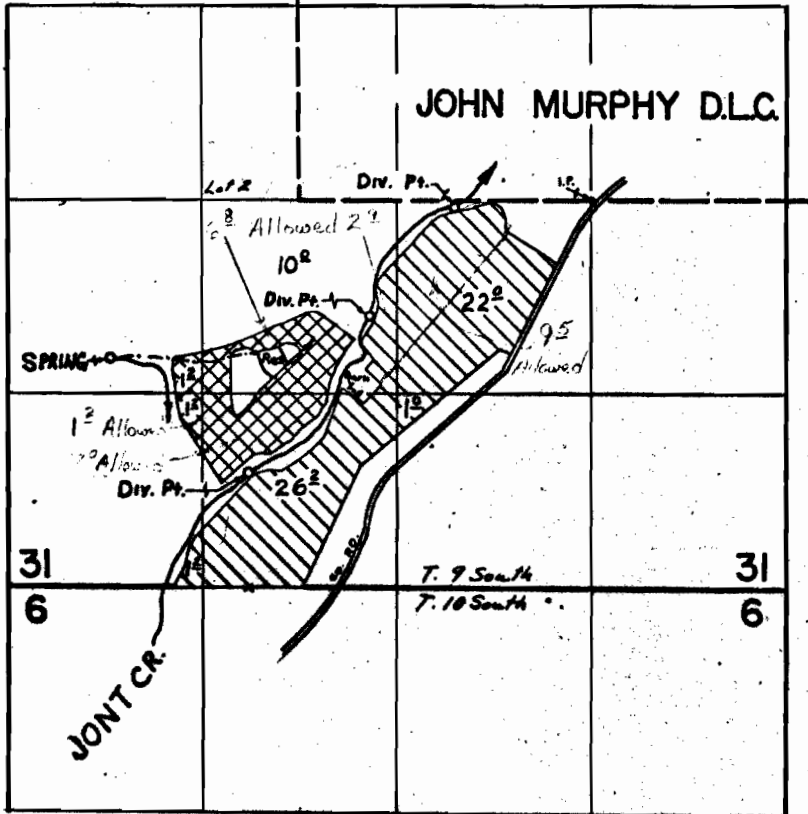

T.9&10S. R.5W. WM.



Div. Pts. Loc: 1860'S. & 2320'W., 780'S. & 1500'W., 40'S. & 920'W., Spring Loc: 1080'S. & 3270' W
 Res: 1050'S & 2000'W. 011 FROM NE CORNER NW 1/4 SE 1/4 Sec. 31

 - Joint Cr.
 - Spring & Res.

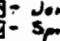
FINAL PROOF SURVEY
 UNDER

Application No. 45460 R-45459 Permit No. 33924 R-5373
 IN NAME OF

ARNOLD D. KENNEY

Surveyed MAR. 15. 1973, by R. MUCKEN