

Permit: S 15606  
Volume: 6  
Strm: APPLEGATE R  
Trib: ROGUE R  
Priority: 9/17/43

*0-1577*

T.36 S. R.6 W. W.M.

RECEIVED  
NOV 24 1976

WM. DIST. 14  
GRANTS PASS. ORE.

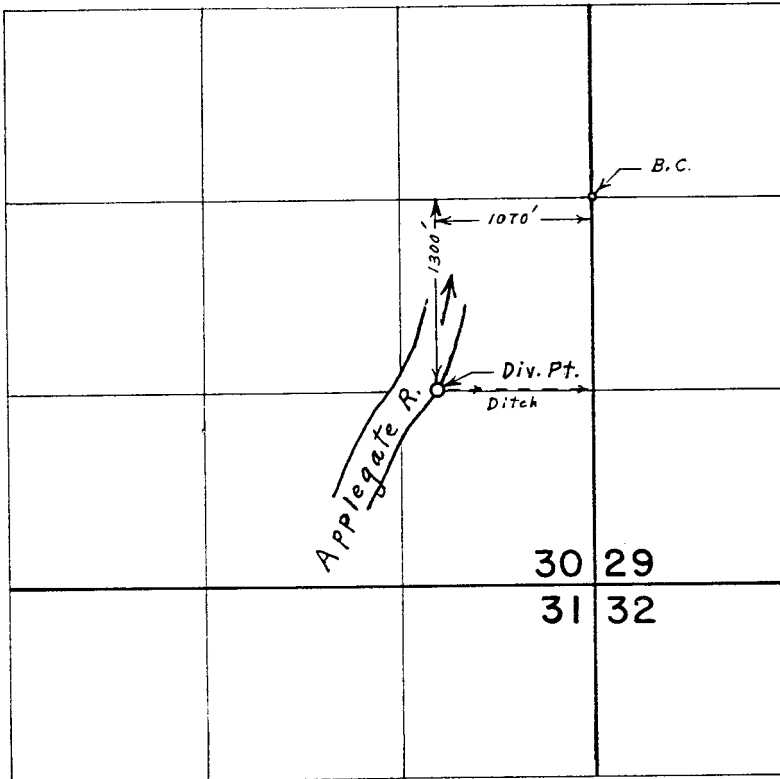

**FINAL PROOF SURVEY**  
UNDER

Application No. \_\_\_\_\_ *Transfer No. 2792*  
Permit No. \_\_\_\_\_

IN NAME OF

**THOMAS R. HART JR.**

Surveyed *May 20, 1974*, by *L. E. Gould*