

T.11S., R.6W., W.M.

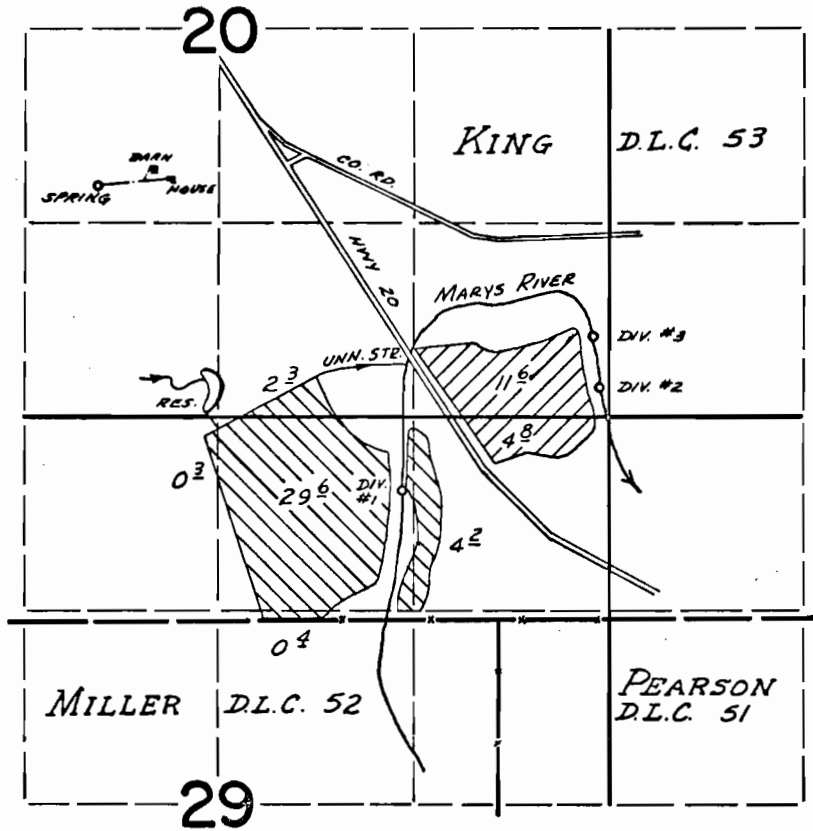

SPRING LOCATED: 2950' N & 2720' W FROM NW COR PEARSON DLC 51
 RES. LOCATED: 1400' N & 1970' W " " " " " "
 DIV. PT. 1 LOCATED: 870' N & 650' W " " " " " "
 DIV. PT. 2 LOCATED: 1570' N & 680' E " " " " " "
 DIV. PT. 3 LOCATED: 1930' N & 640' E " " " " " "

FINAL PROOF SURVEY UNDER

Application No. 42851 Permit No. 32026
R-44249 R-5111
 Application No. 44250 Permit No. 33051
 IN NAME OF

CARL F. MULLER

Surveyed MARCH 20 1973, by D. NORBY