

T.3S. R.8½E. W.M.

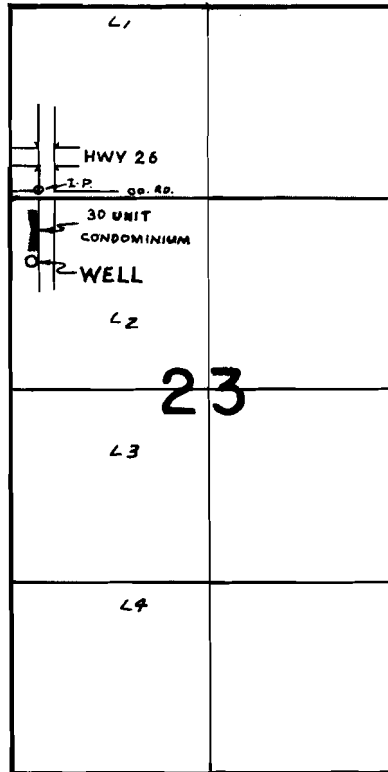

WELL LOC: 1750' S., 150' E. FROM NW COR. SEC 23

FINAL PROOF SURVEY
UNDER

Application No. G-4350 Permit No. G-4185
IN NAME OF

GEORGE I. HANSEN

Surveyed SEPT. 13, 1973, by R. MUCKEN