

T.8S. R.5W. W.M.

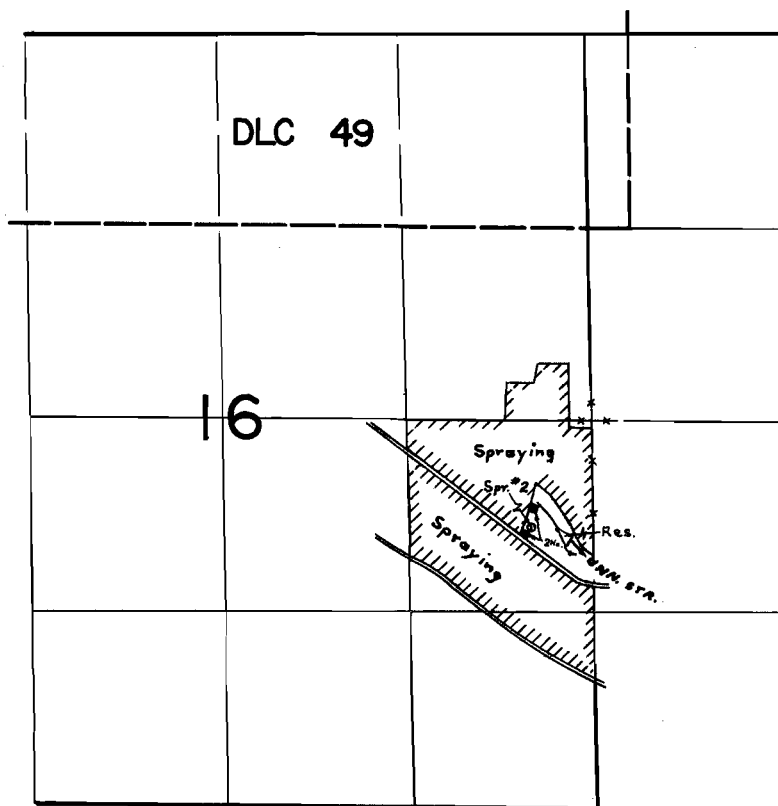

Spring Loc: 740' S. & 430' W. from E. 1/4 cor. Sec. 16
Dam Loc: 810' S. & 160' W. from E. 1/4 cor. Sec. 16

FINAL PROOF SURVEY
UNDER

Application No. 47783 Permit No. 35803
R-47782
IN NAME OF

ROBERT E. SHINGLER

Surveyed JUNE 20, 1973, by T. PAUL