

T.37S. R.7W. W.M.

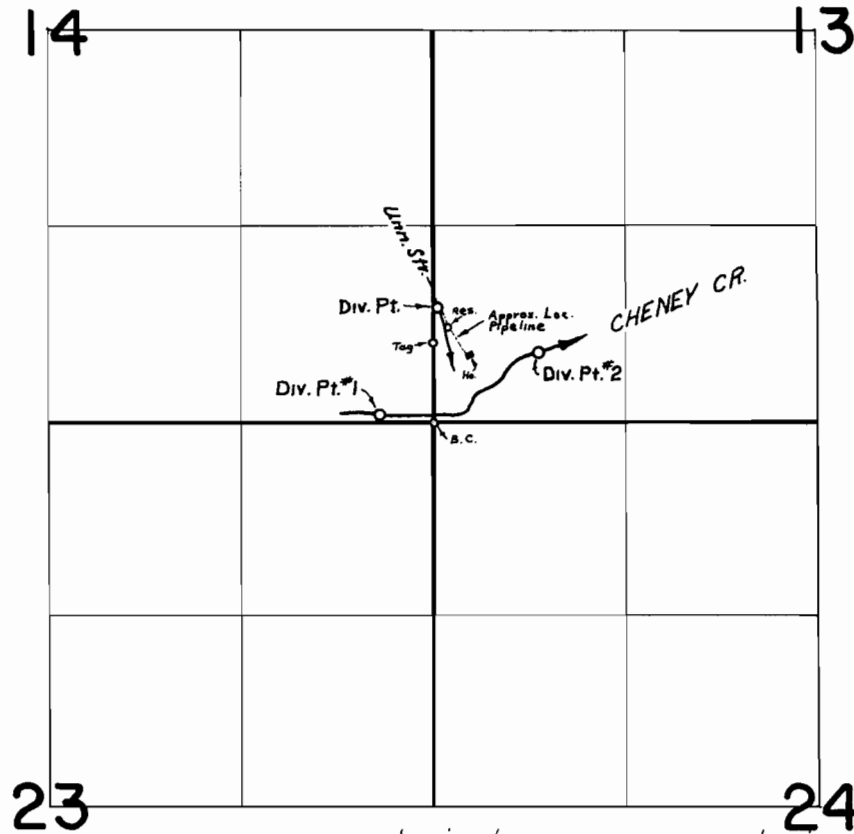

Div. Pts. Loc: Unn. Str. - 800' N. $\frac{1}{2}$ 30' E., Cheney Cr. #1 - 50' N. $\frac{1}{2}$ 370' W., and Cheney Cr. #2 - 480' N. $\frac{1}{2}$ 720' E. all from SW. cor. Sec. 13

FINAL PROOF SURVEY
UNDER

Application No. 47527 Transfer No. P-102
Permit No. 35592
IN NAME OF

CALVIN C. PIKE

Surveyed MAY 22, 1974, by L. E. GOULD