

T. I. N. R. I. E. W. M.

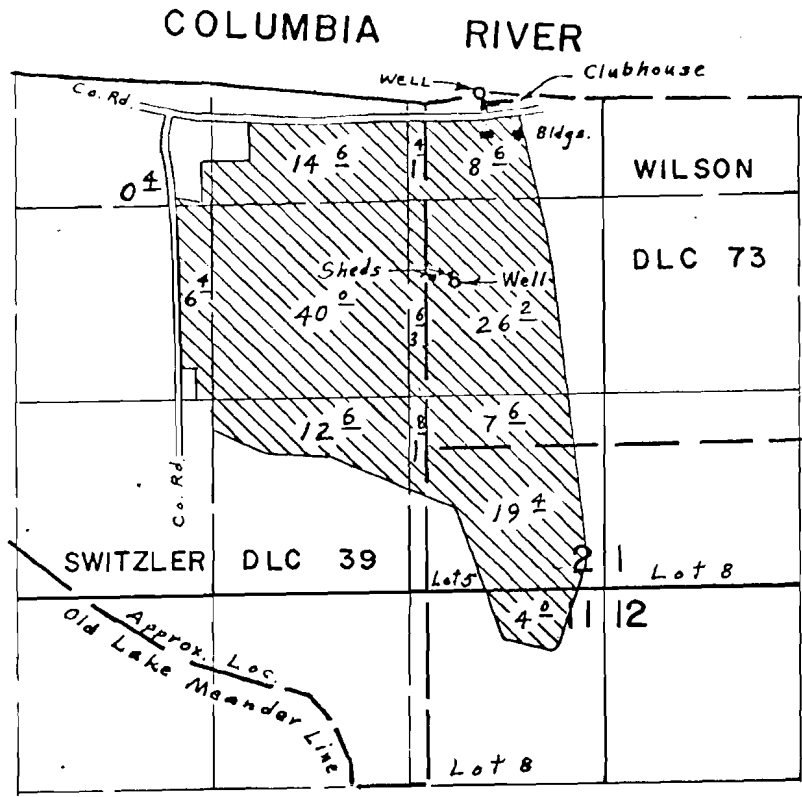

Wells located: 60' N. & 370' E.; 1200' S. & 190' E. both from N.W. Cor. Wilson D.L.C. 73

FINAL PROOF SURVEY UNDER

G-5152 G-4884
Application No. G-4023 Permit No. G-3772
IN NAME OF

COLUMBIA-EDGEWATER COUNTRY CLUB

Surveyed April 30, 1973, by L. E. Gould