

T.2S. R.1&2W. W.M.

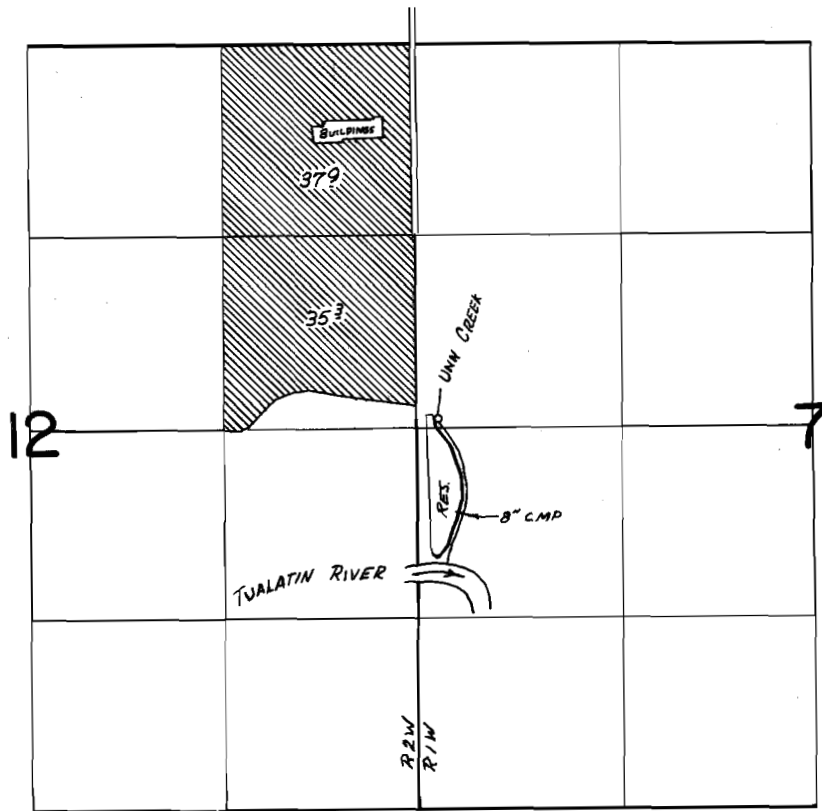

CREEK Div. Loc. 2580'S ± 150'E ; RES. Loc. 3210'S ± 280'E BOTH FROM NW COR SEC 7.

FINAL PROOF SURVEY
UNDER

R-49470 R-6019
Application No. 49471 Permit No. 37057
IN NAME OF

..... FRED B. GRABHORN

Surveyed June 19, 1974, by R. G. MUCKEN