

T. 33 S. R. 6 W. W. M.

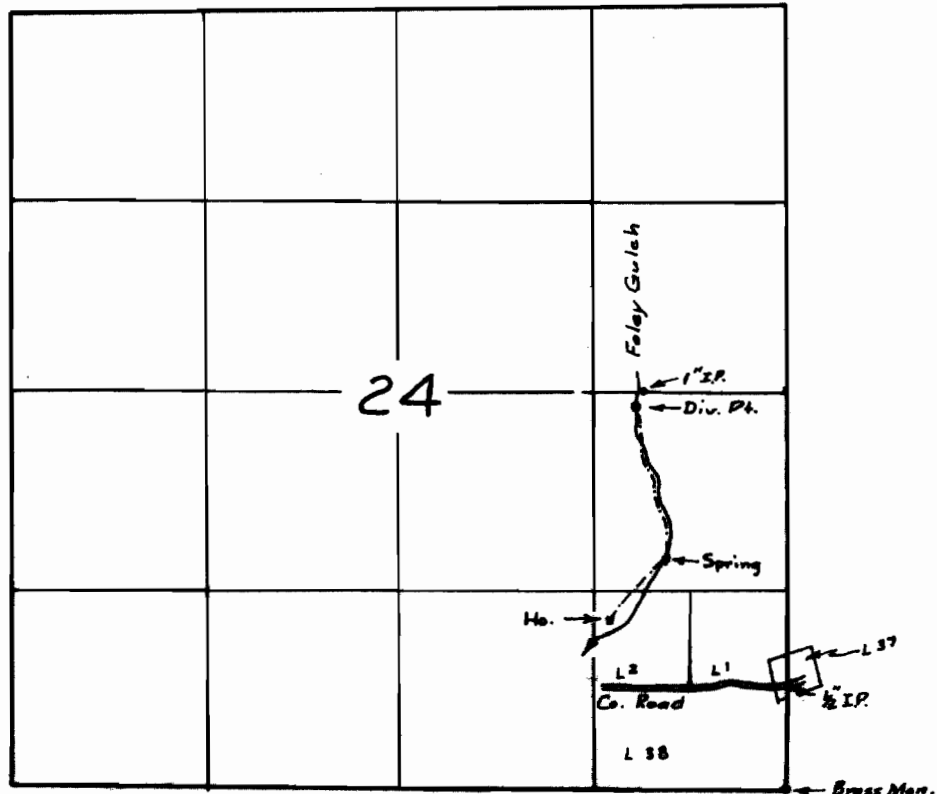

Div. Pt. located 2620' N & 1040' W
Spring located 1580' N & 840' W Both from the S.E. Cor. Sec. 24

FINAL PROOF SURVEY
UNDER

Application No. 34196 Permit No. 26942
IN NAME OF

EMMIT R. CROUSE & ROSALTA M. CROUSE

Surveyed June 10, 1963, by R. Jackson