

T.15S.R.47E.W.M.

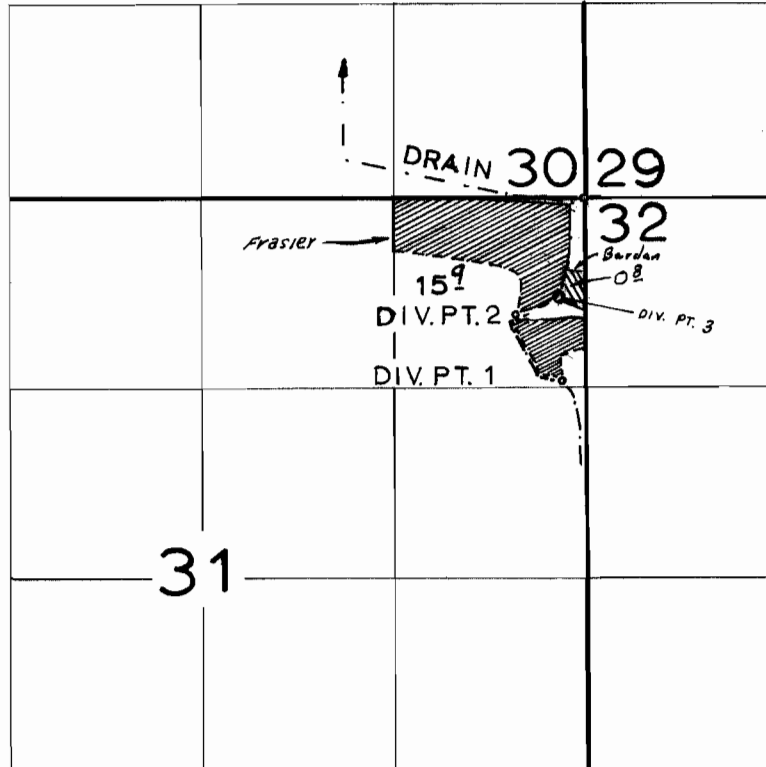

DIV. PT. 1 IS 160' W. & 1270' S. FROM NE. COR. SEC. 31  
DIV. PT. 2 IS 460' W. & 825' S. FROM NE. COR. SEC. 31  
DIV. PT. 3 - 680' S. & 190' W. FROM NE. COR. SEC. 31

**FINAL PROOF SURVEY**  
UNDER

Application No. 38072... Permit No. 29759  
IN NAME OF

*Harry & Pearl R. Frasier & George D. Bardan*

Surveyed SEPT. 16. 1970, by ELFERING  
JUN. 18 1974 L. H. NUNN