

T.9S. R.4W. W.M.

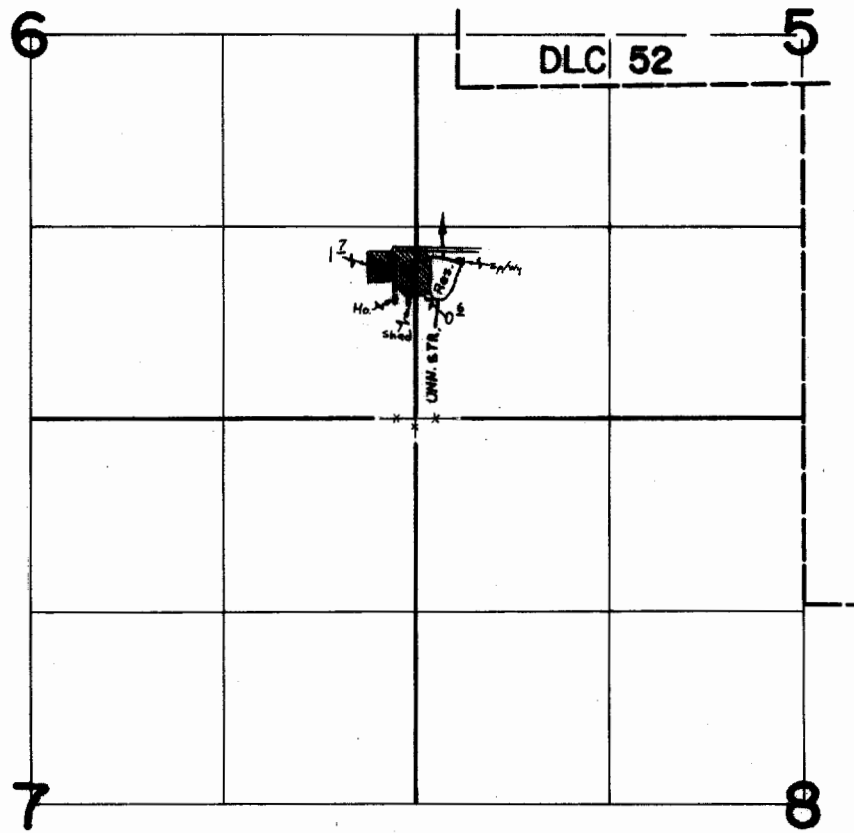

Div. Pt. Loc: 1090' N. & 180' E. from SW cor. Section 5

**FINAL PROOF SURVEY**  
UNDER

Application No. 44860 R- 44859 Permit No. 33544 R- 5300  
IN NAME OF

*RICHARD S. & EUNICE HOFFMAN*

Surveyed MARCH 29 1974, by R. MUCKEN