

T.9 S. R.6 W.W.M.

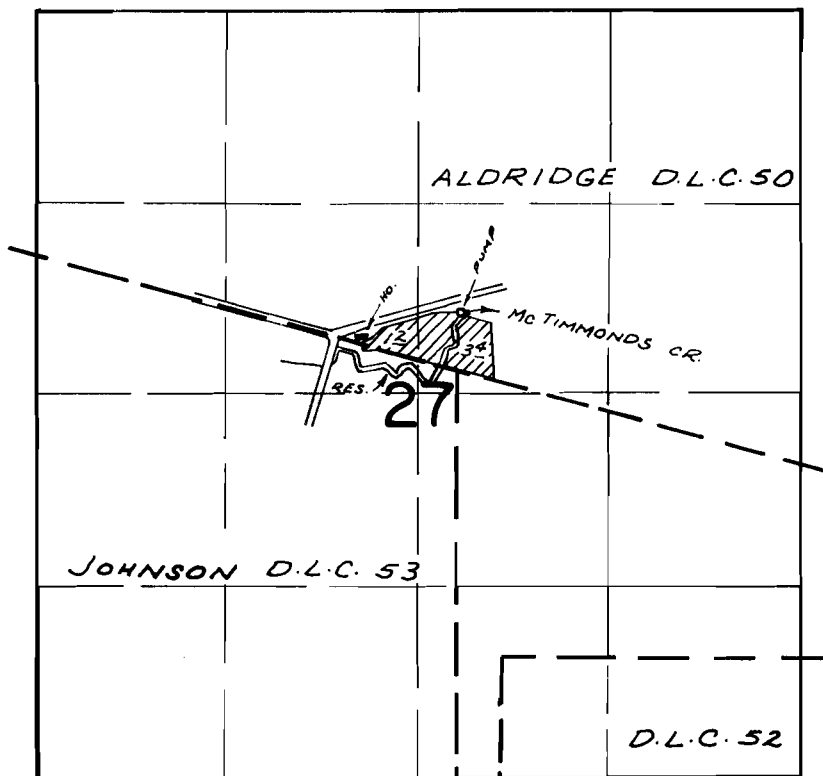

DIV. PTS. LOC: 380'N. & 30'E, 380'N & 70'E, BOTH FROM N.E. COR. JOHNSON DLC 53

FINAL PROOF SURVEY
UNDER

Application No. *R-46350* ~~46351~~ Permit No. *R-5515* ~~29627~~
IN NAME OF

.....*PAUL MADDUX*.....

Surveyed *MAR. 27 1973*, by *R. MURKEN*