

T.9 S. R.6 W.W.M.

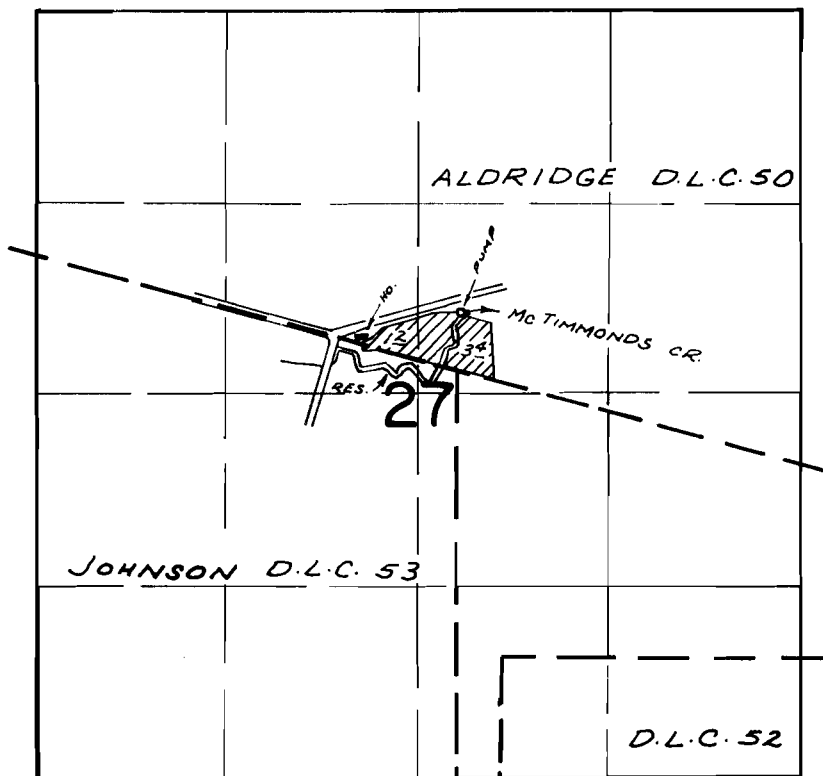

DIV. PTS. LOC: 380' N. & 30' E, 380' N & 70' E, BOTH FROM N.E. COR. JOHNSON DLC 53

FINAL PROOF SURVEY UNDER

Application No. R-46350 Permit No. R-5515
46351 39627
IN NAME OF

PAUL MADDUX

Surveyed MAR. 27 1973, by R. MURKEN