

T.I.S.R.2W.W.M.

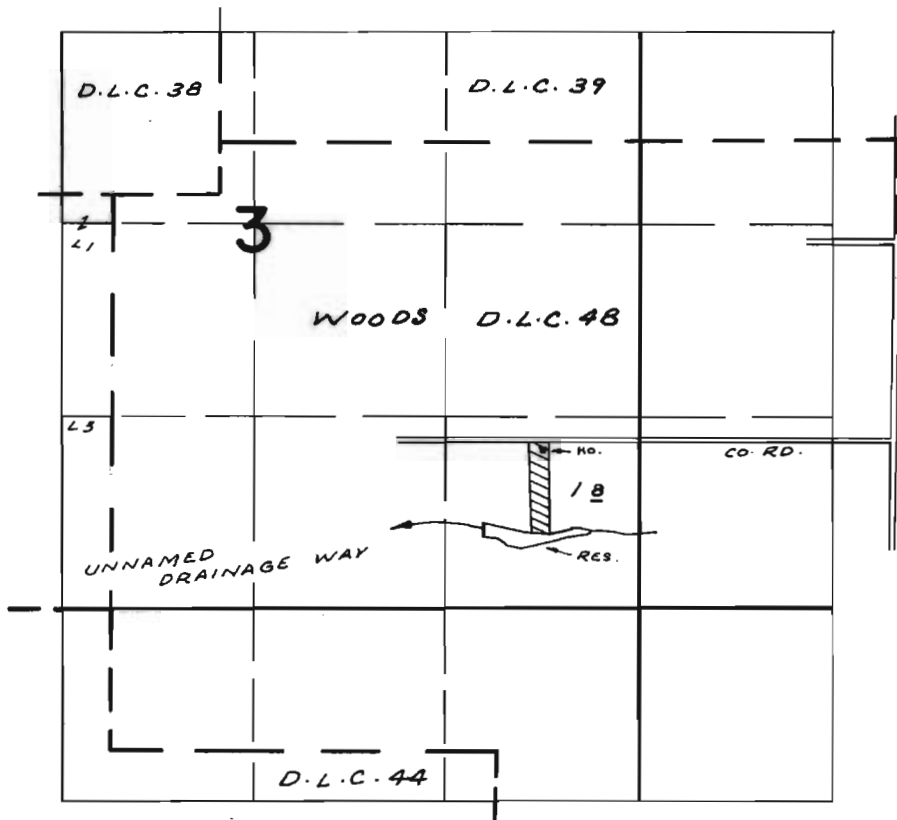

DIV. PT. LOC: 2660' S. & 2820' W. FROM N.E. COR. WOODS D.L.C. 48

**FINAL PROOF SURVEY**  
UNDER

Application No. 46121 Permit No. 34457  
IN NAME OF

*Scott L. & Sharon M. Smith*

Surveyed OCT. 30 1972, by R. MUCKEN