

T.14S., R.5W., W.M.

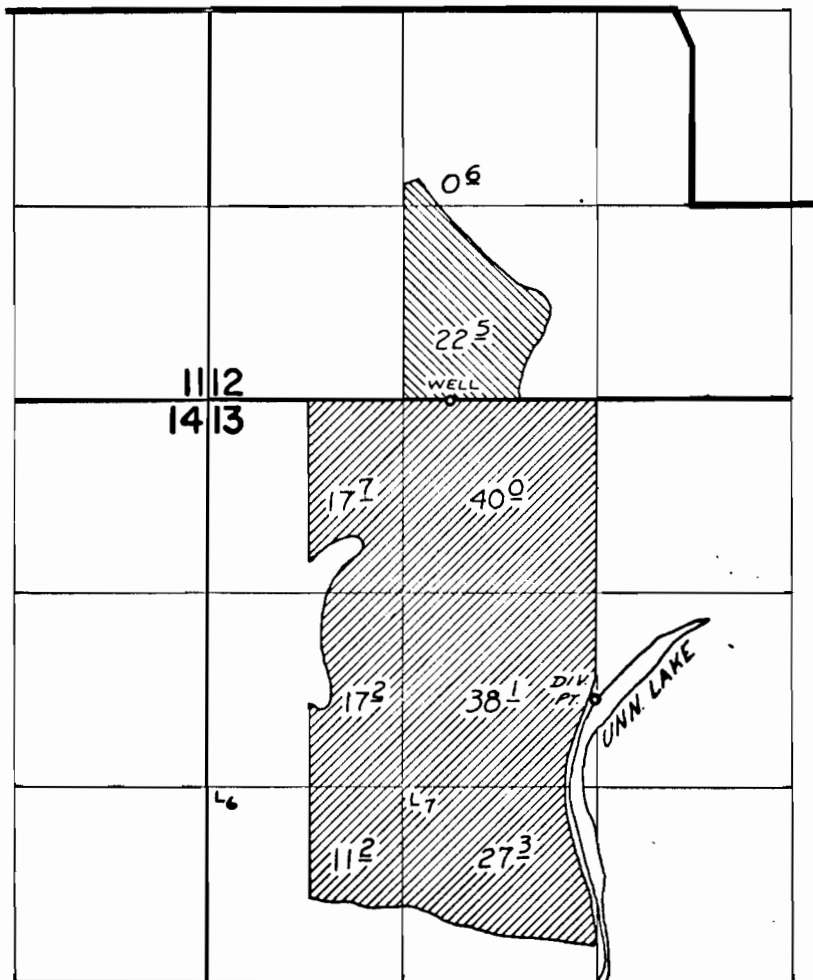

WELL LOCATED: 10' N & 1000' W FROM  $5\frac{1}{4}$  COR SEC. 12  
DIK. PT. LOCATED: 2030' S & 10' W FROM  $N\frac{1}{4}$  COR SEC. 18

**FINAL PROOF SURVEY**  
UNDER

G-4397

G-4145



Application No. 44938 Permit No. 33585



IN NAME OF

VOLNEY VOLKER

Surveyed APRIL 5 1973, by D. NORBY