

T.14S., R.5W., W.M.

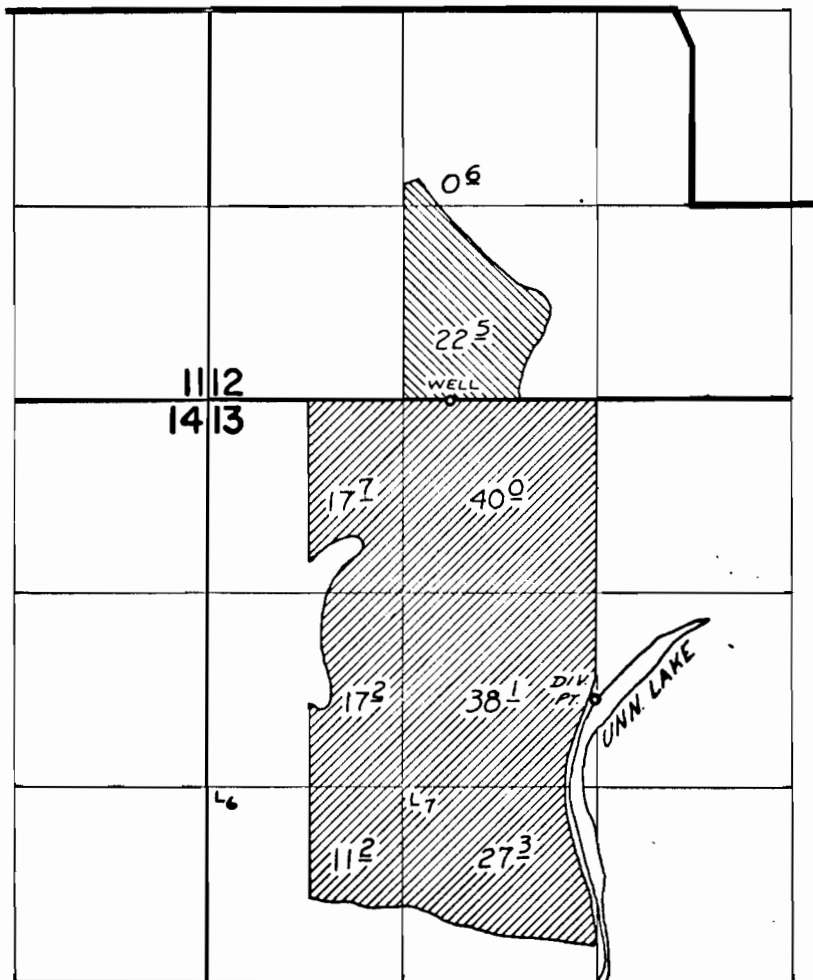

WELL LOCATED: 10' N & 1000' W FROM S $\frac{1}{4}$ COR SEC. 18
DIV. PT. LOCATED: 2030' S & 10' W FROM N $\frac{1}{4}$ COR SEC. 18

FINAL PROOF SURVEY
UNDER

G-4397

G-4145

Application No. 44938 Permit No. 33585

IN NAME OF

VOLNEY VOLKER

Surveyed APRIL 5 1973, by D. NORBY

