

T. 5S., R. 2E., W.M.

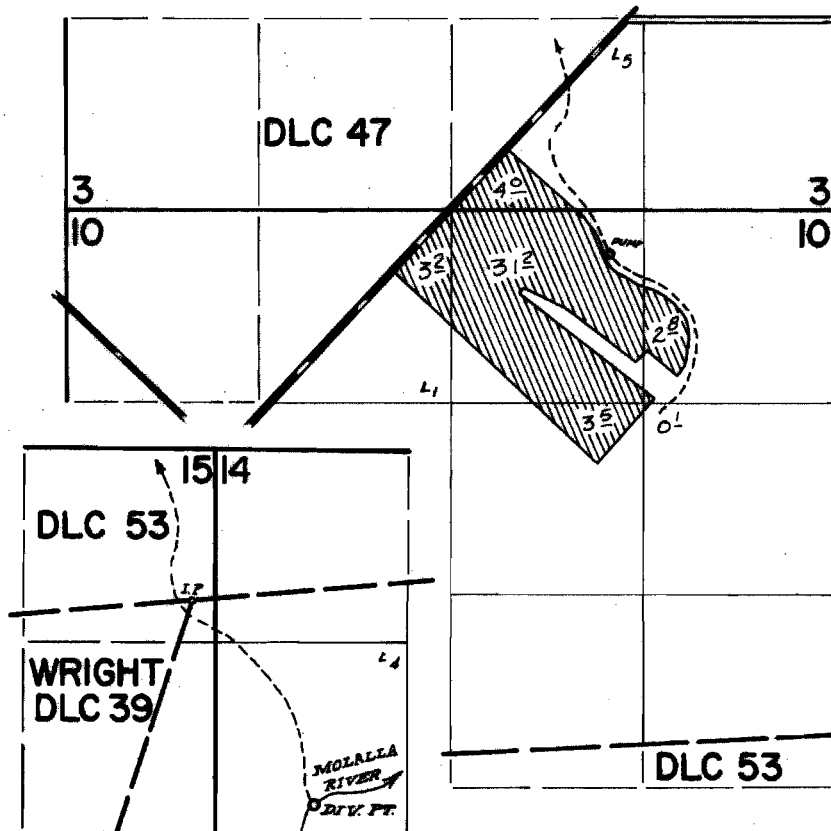

DIV. PT. LOCATED: 1390'S & 850'E FROM NE COR. WRIGHT DLC 39.

**FINAL PROOF SURVEY**  
UNDER

Application No. 47072 Permit No. 35205  
IN NAME OF

*JOHN M. & VERNA A. HANSON*

Surveyed Sept. 20 1974, by *a. Dorby*