

# SPRINGFIELD UTILITY BOARD

## WELL FIELD

No. 2

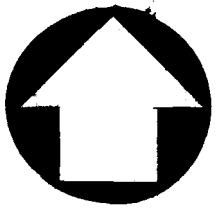

NORTH

1" = 300'

**RECEIVED**  
APR 24 1969  
STATE ENGINEER  
SALEM, OREGON

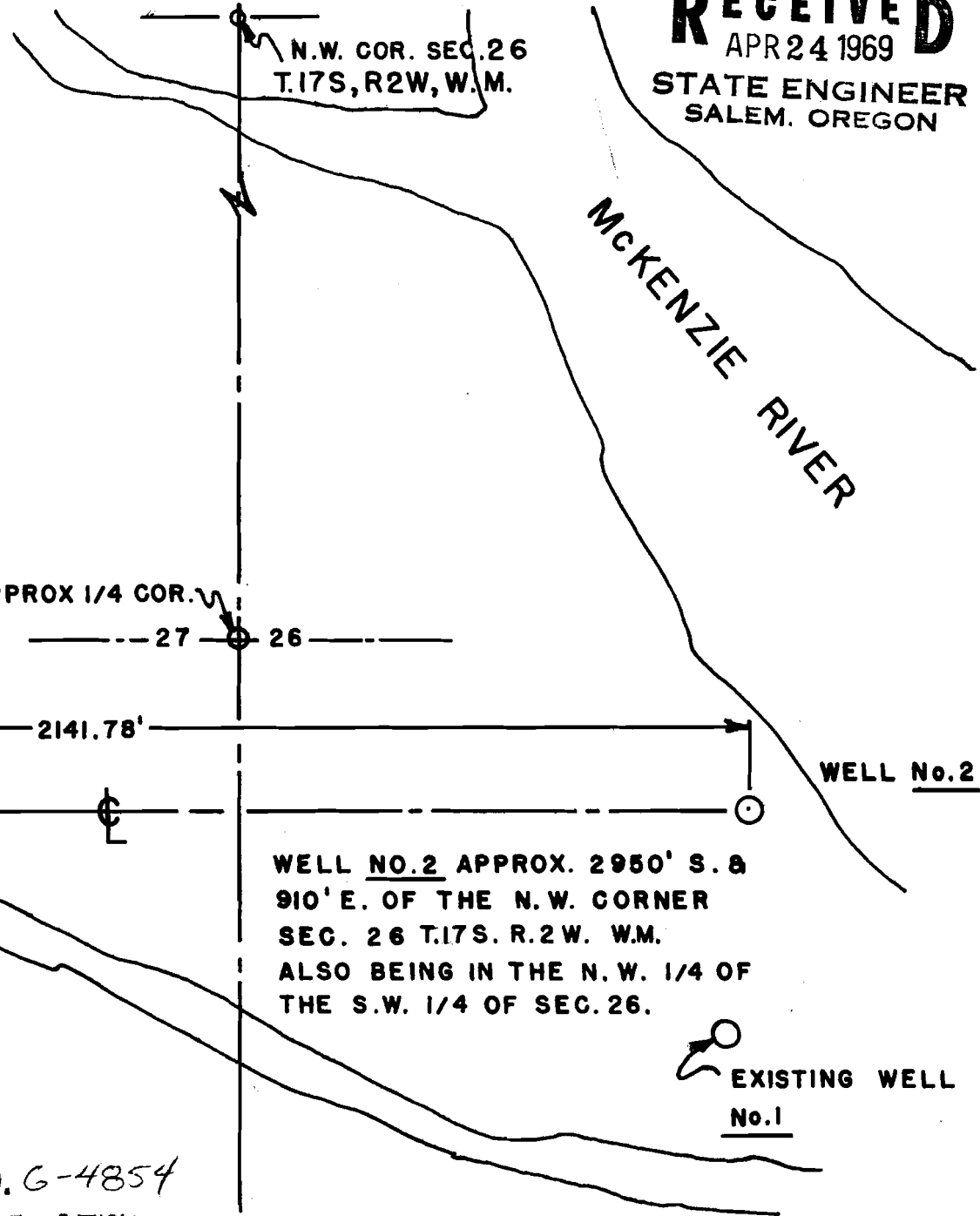

N.E. COR.  
DAVID McNUTT  
D.L.C. NO. 75

644.98'

APPROX 1/4 COR.

--- 27 --- 26 ---

2141.78'

WELL No. 2

CENTER LINE OF WELL  
No. 2 IS 644.98' SOUTH  
& 2141.78' EAST OF N.E.  
CORNER OF THE  
DAVID McNUTT D.L.C.  
NO. 75.

20' RDWY.

WELL NO. 2 APPROX. 2950' S. &  
910' E. OF THE N.W. CORNER  
SEC. 26 T.17S. R.2W. W.M.  
ALSO BEING IN THE N.W. 1/4 OF  
THE S.W. 1/4 OF SEC. 26.

EXISTING WELL  
No. 1

Application No. G-4854  
Permit No. G 4570

WATER DISTRIBUTION AREA

**RECEIVED**  
APR 24 1969  
STATE ENGINEER  
SALEM, OREGON

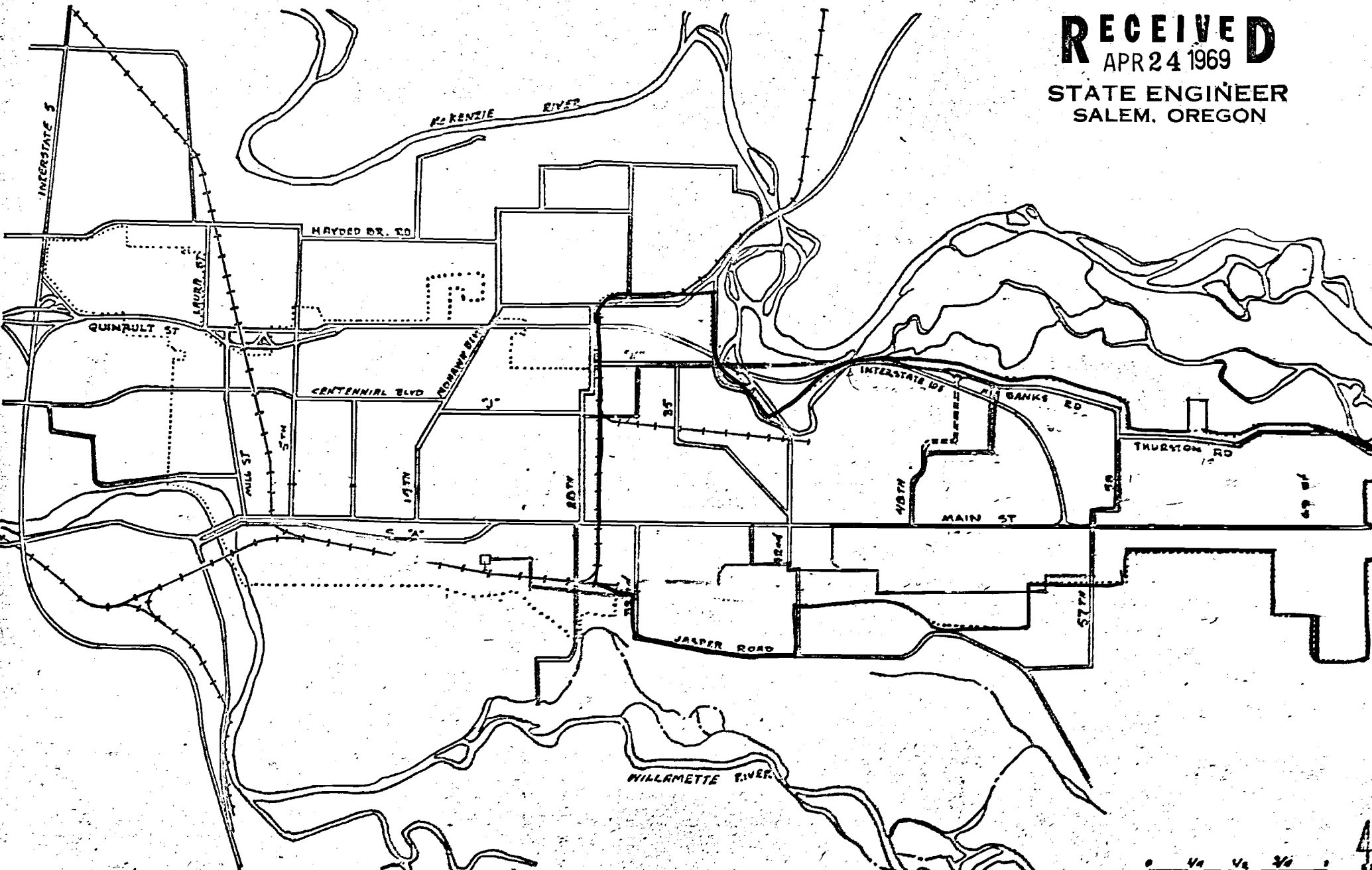

Application No. G-4854  
Permit No. G 4570

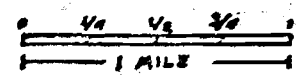

SPRINGFIELD  
SPRINGFIELD UTILITY BOARD