

T.18S.R.2W.W.M.

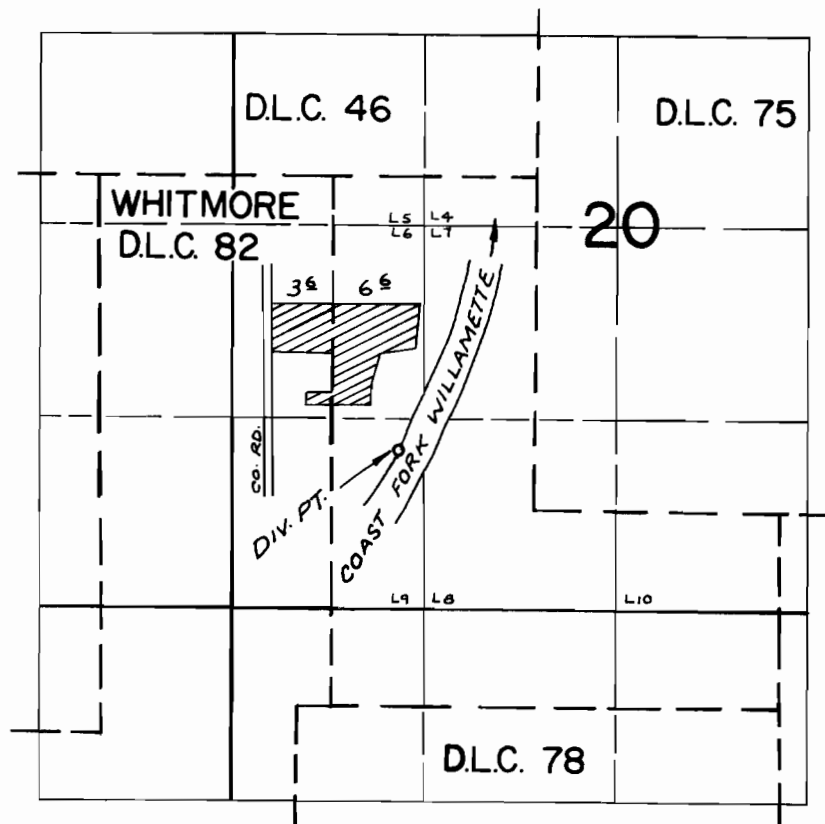

DIV. PT. LOC: 1880'S. & 2050'E. FROM N.W. COR. WHITMORE D.L.C. 82

FINAL PROOF SURVEY
UNDER

Application No. ~~44893~~ Permit No. ~~33566~~
IN NAME OF

Gertrude A. Dilley

Surveyed *MAY 8, 1974*, by *R. MUCKEN*