

T.11S., R.4W., W.M.

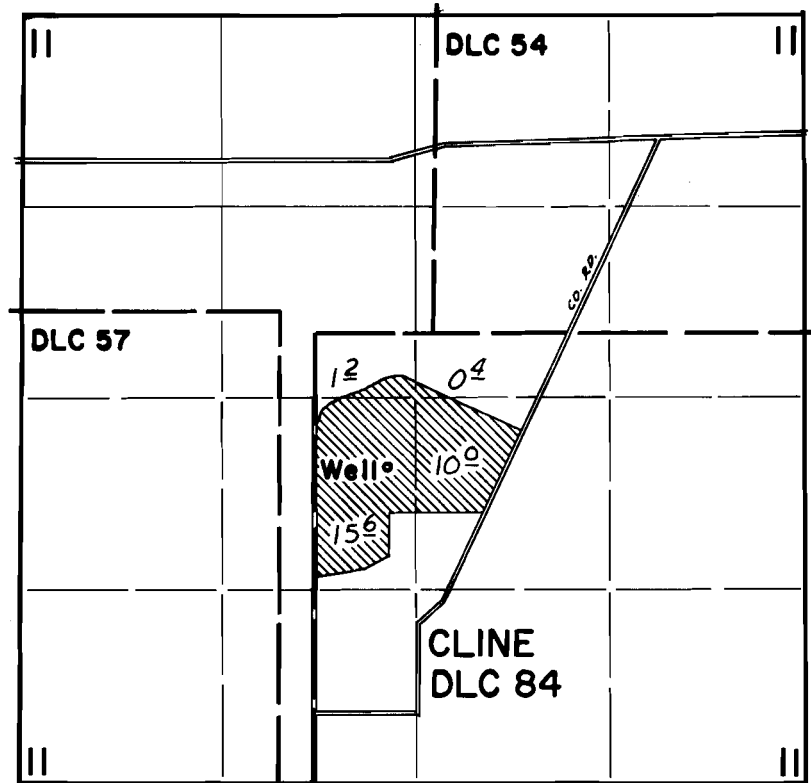

WELL LOCATED: 910' S & 500' E FROM NW COR CLINE DLC 54.

FINAL PROOF SURVEY UNDER

Application No. G-5165 Permit No. G-4897
IN NAME OF

MORRIS H. AND DOROTHY M. BERGMAN

Surveyed Oct. 1, 1973, by D. Norby