

T. 7 S. R. 1 W. W. M.

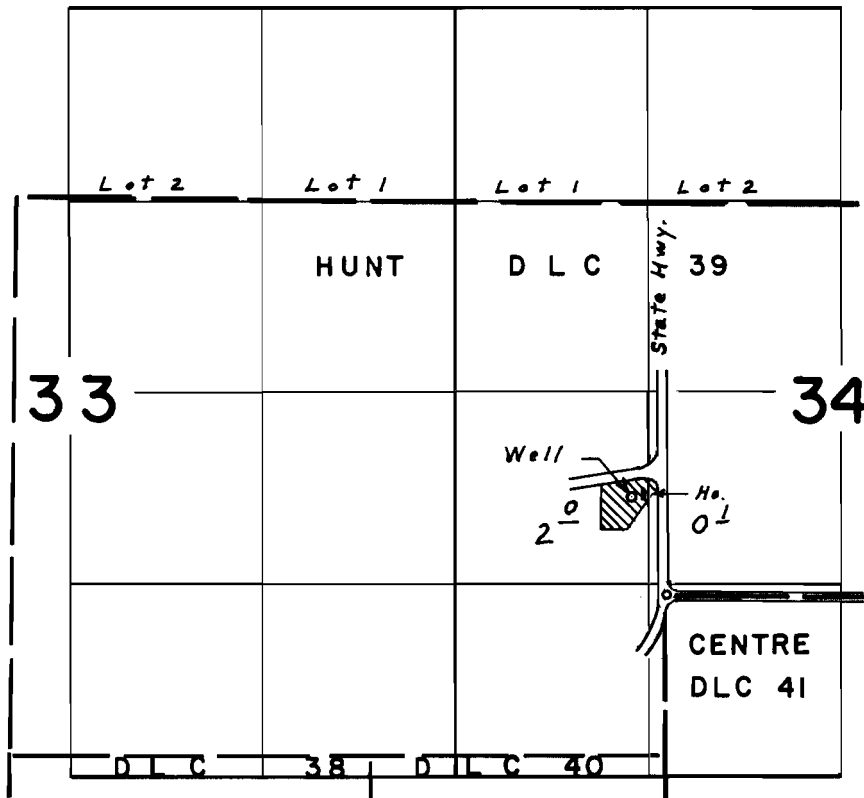

Well located 670' S. & 280' E. from N.W. Cor. Centre D.L.C. 41

**FINAL PROOF SURVEY**  
UNDER

Application No. G-3790 Permit No. G-3573  
IN NAME OF

IDA B. JOHNSON

Surveyed July 3, 1973, by L. E. Gould