

T. 3S. R. 5W. W.M.

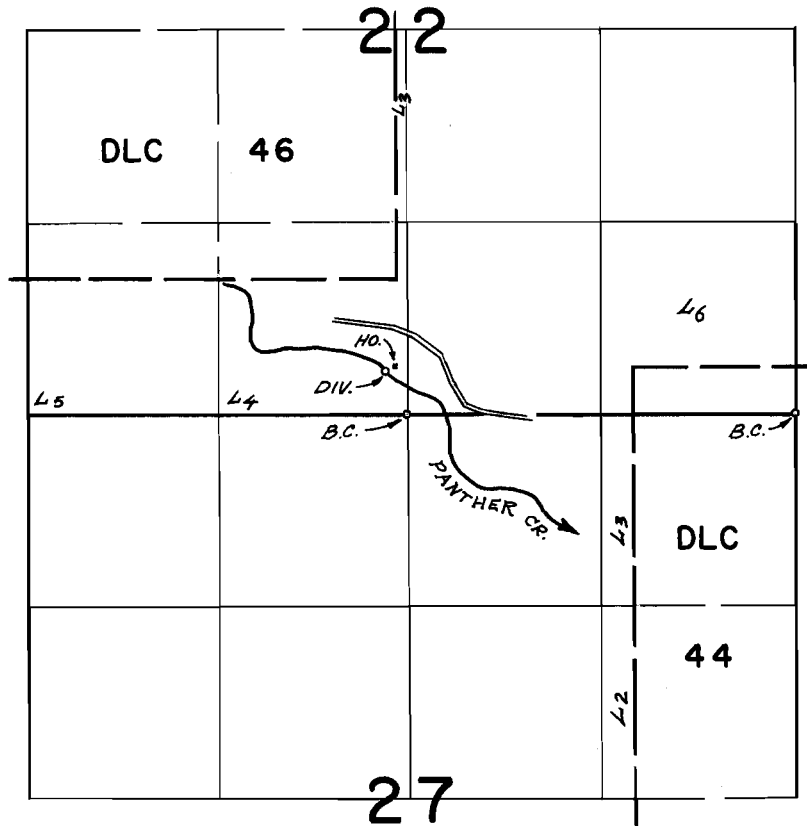

DIV. PT.; 300' N., 150' W., FROM S. 1/4 COR. SECTION 22

**FINAL PROOF SURVEY**  
UNDER

Application No. 48306 Permit No. 36273  
IN NAME OF

CHRISTIAN V. & ANNETTA M. HORLYK.

Surveyed APRIL 25 1973, by L. GOULD