

# T.10S. R.4W. W.M.

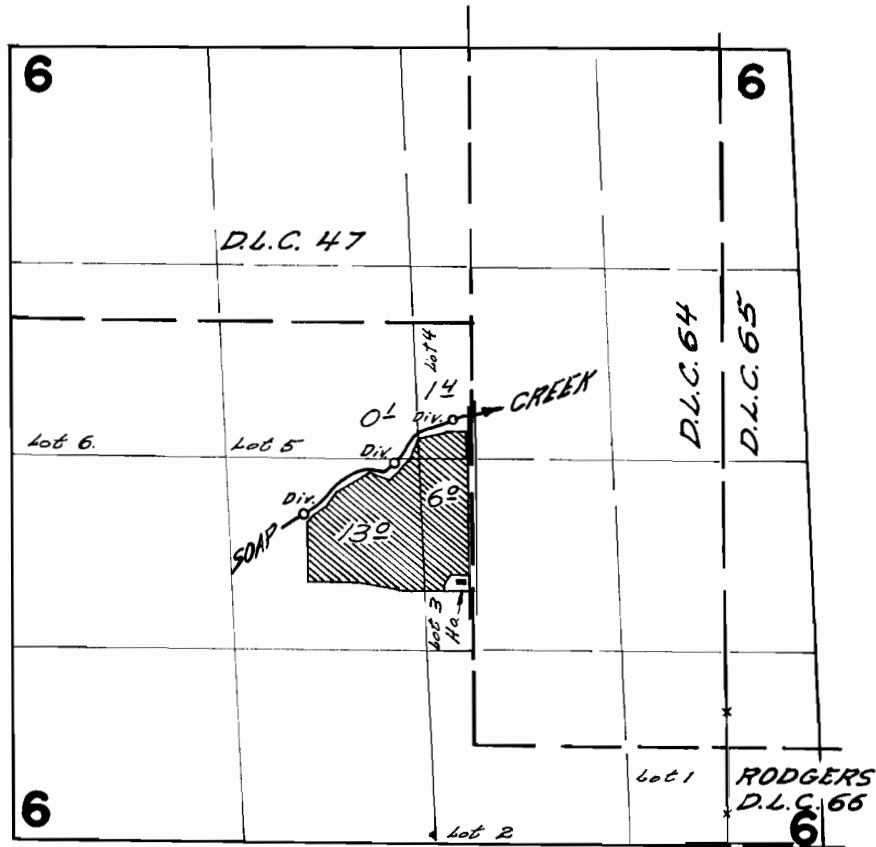

DIVERSION POINTS LOCATED 2260 F.N. & 2880 F.G. W.  
 2610 F.N. & 2250 F.G. W.  
 2920 F.N. & 1850 F.G. W.  
 ALL FROM THE MOST WESTERLY SW. CORNER D.L.C. 66

## FINAL PROOF SURVEY UNDER

Application No. 35208 Permit No. 27545  
 IN NAME OF

RALPH B. GRAHAM

Surveyed Aug 16, 1965, by C. GARDNER  
Sept. 26, 1968 by W.J. Fluppert