

T.38S.,R.5W.,W.M.

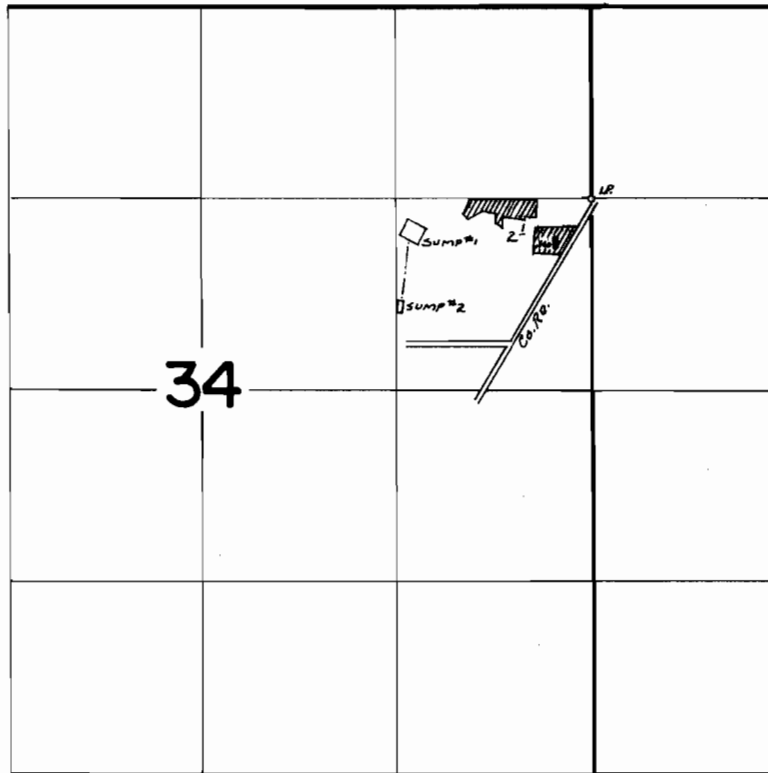

SUMP #1 : 200'S AND 1200' W } FROM SE COR OF NE 1/4 NE 1/4 OF SEC. 34
SUMP #2 : 700'S AND 1300' W }

FINAL PROOF SURVEY
UNDER

Application No. G-4742 Permit No. G-4462
IN NAME OF

Steven Williams & David Oswald

Surveyed SEPT. 19 1974, by L. TOLL.....