

RECEIVED

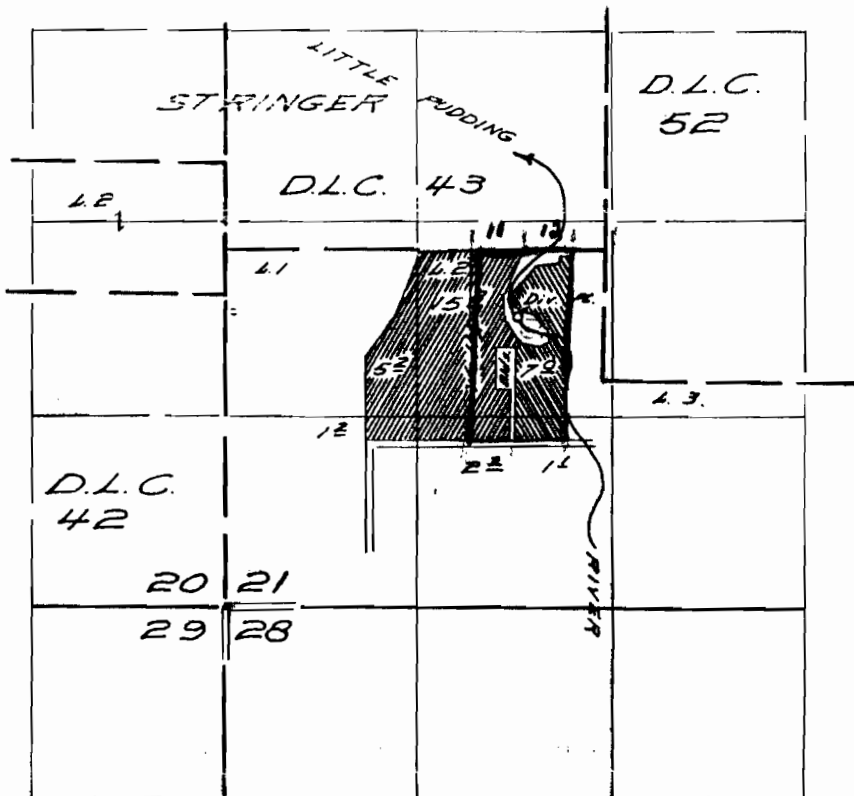

FEB 09 2000

WATER RESOURCES DEPT.
SALEM, OREGON

T. 7 S. R. 2 W. W.M.



Well located 1930 ft. N. & 1680 ft. E. bolt from S.W. Cor. Sec. 21
Div. 18. Located 1980 ft. N. & 1990 ft. E.

-  Primary from Well
-  Primary from Little Pudding River & Supplemental from Well

FINAL PROOF SURVEY
UNDER

G-3183 G-2989
Application No. 41170 Permit No. 30690
IN NAME OF

FRED T. HEINZ

Surveyed March 21 1967, by W. d. Ruppert.