

T.9S., R.1E., W.M.

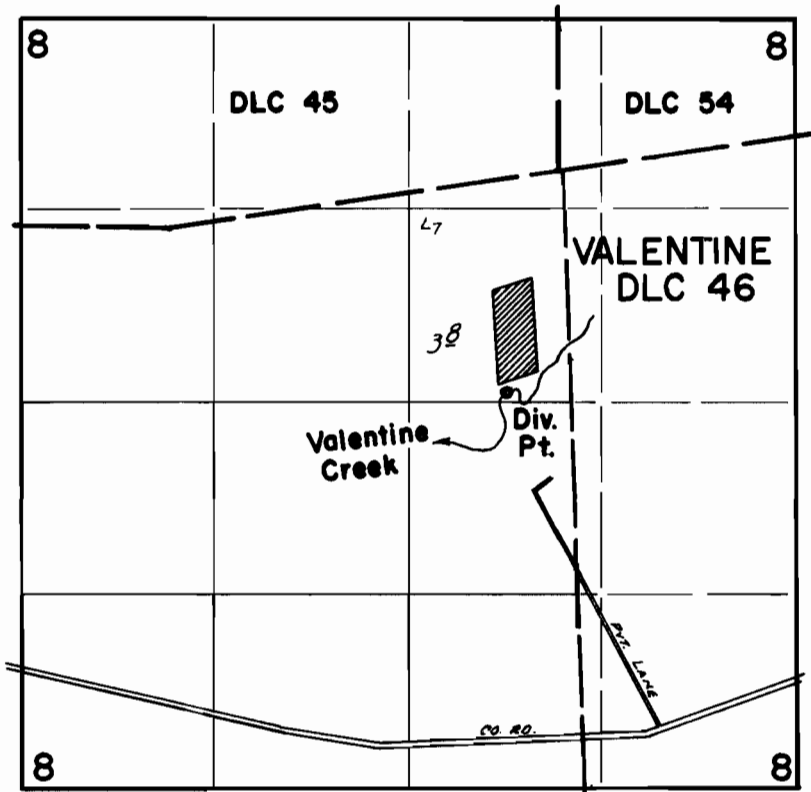

DIV. PT. LOCATED: 1520' S & 390' W FROM NW COR. VALENTINE DLC 46.

FINAL PROOF SURVEY UNDER

Application No. 46140 Permit No. 34472
IN NAME OF

HENRY SILBERNAGEL

Surveyed July 3, 1973, by D. Norby