

T.7S. R.1&2W. W.M.

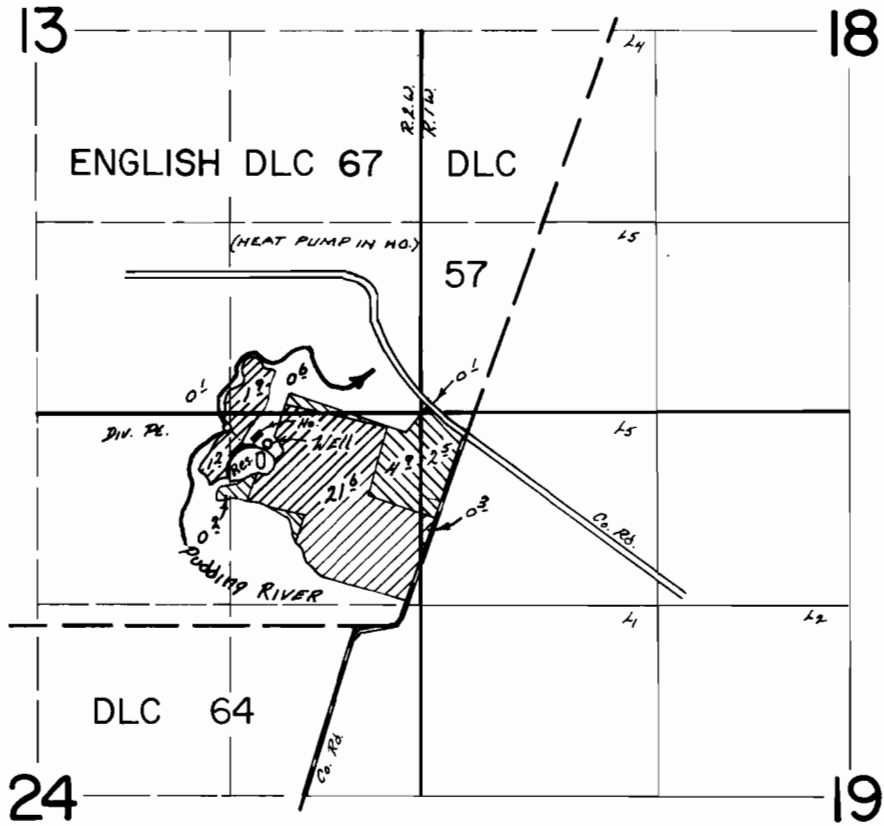

Div. Pt. Loc. RIVER - 1350' N & 1160' W ; Res. - 1230' N & 1050' W ;  
Well - 1250' N & 900' W All From S.E. Cor English DLC 67



Primary

Supplemental

**FINAL PROOF SURVEY**

UNDER

Transfer No. **2910**

G-4689

R-41650

Application No. 41657

Permit No. 31216

G-4410

R-4717

IN NAME OF

HERBERT SPADY

Surveyed May 29 1973 by T.J. Paul

Sept 3 1974

1974

L. TOLL