

G-4491

42270

# T. 1 S., R. 32 E., W.M.

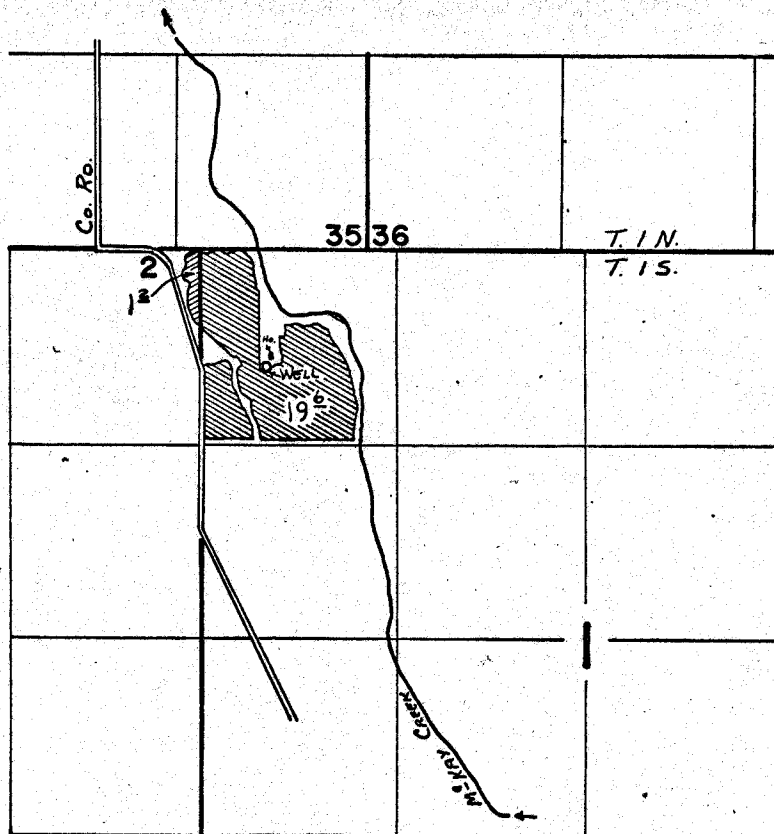

Well Loc: 800'S AND 450'E FROM NW COR. SEC. 1

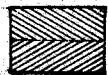

SUPPLEMENTAL IRRIGATION  
 PRIMARY IRRIGATION

## FINAL PROOF SURVEY UNDER

Application No. G-4768. Permit No. G-4491.  
 IN NAME OF

TOM ELLIS

Surveyed Aug. 7 1974, by L. Toll