

T.5S. R.3W. W.M.

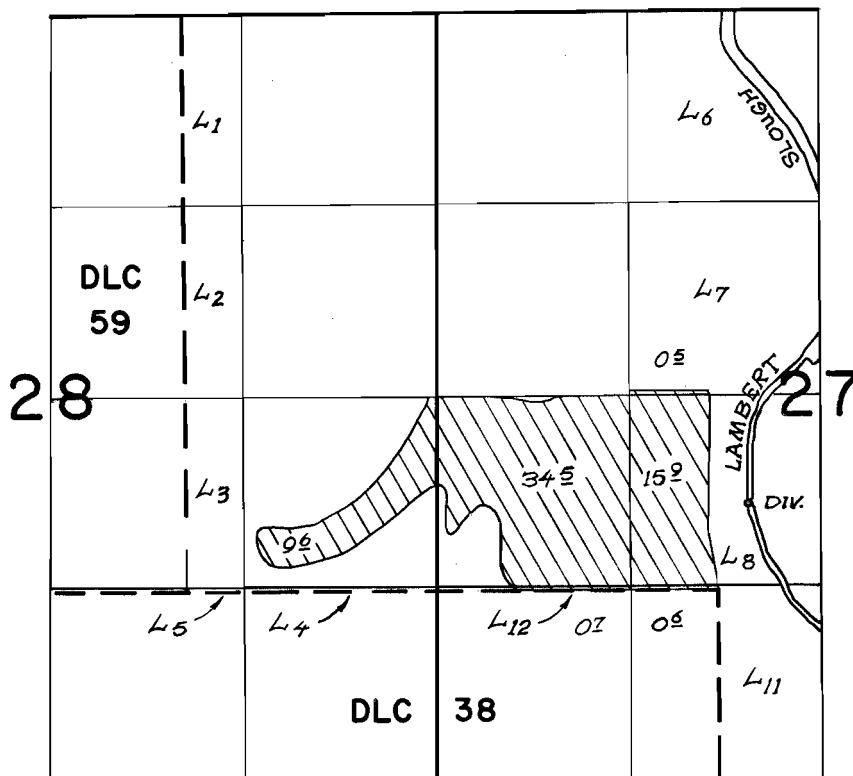

DIV. - 730'S. 2125'E. FROM W. 1/4 COR. SEC. 27

FINAL PROOF SURVEY
UNDER

Application No. 40052 Permit No. 29856
IN NAME OF

LOUIE W. & ROBERT A. MAGEE

Surveyed MARCH 23 1973, by L. GOULD