

# T. 4 S.R. 1W. W.M.

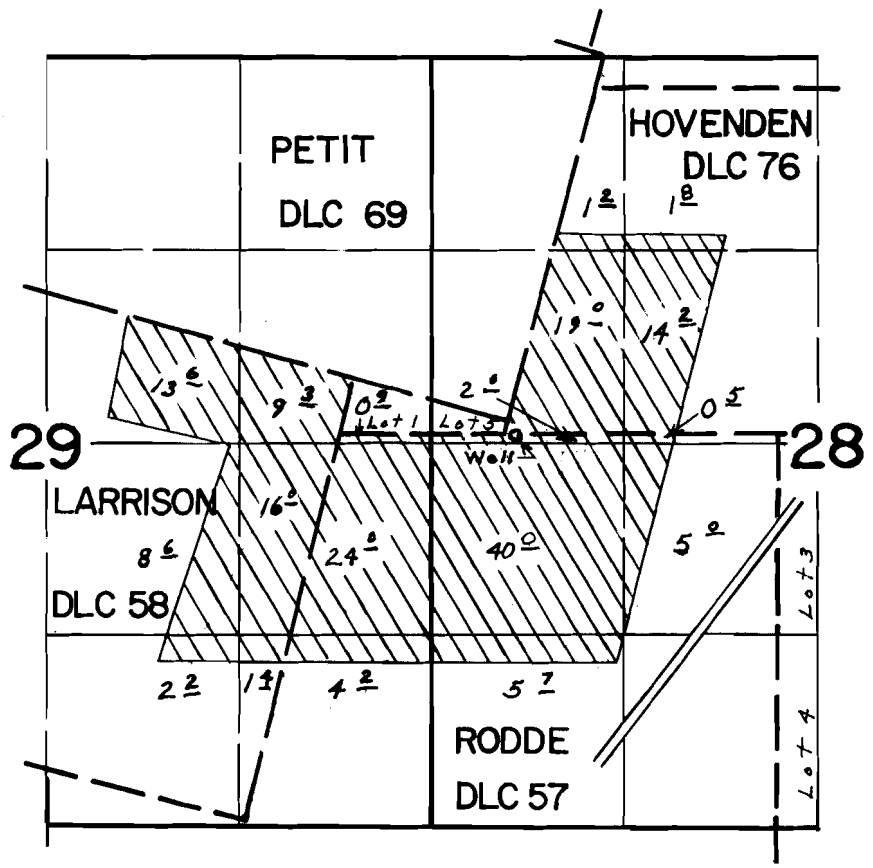

Well loc.: 40 ft. S. of 40 ft. E. from SW Cor. HOVENDEN DLC 76

## FINAL PROOF SURVEY UNDER

Application No. G-4460 Permit No. G-4203  
 IN NAME OF  
CIRCLE FOUR RANCH, INC.  
 Surveyed AUG 15 1973, by L. E. GOULD