

T. 6 S. R. 1 E. W. 1 M.

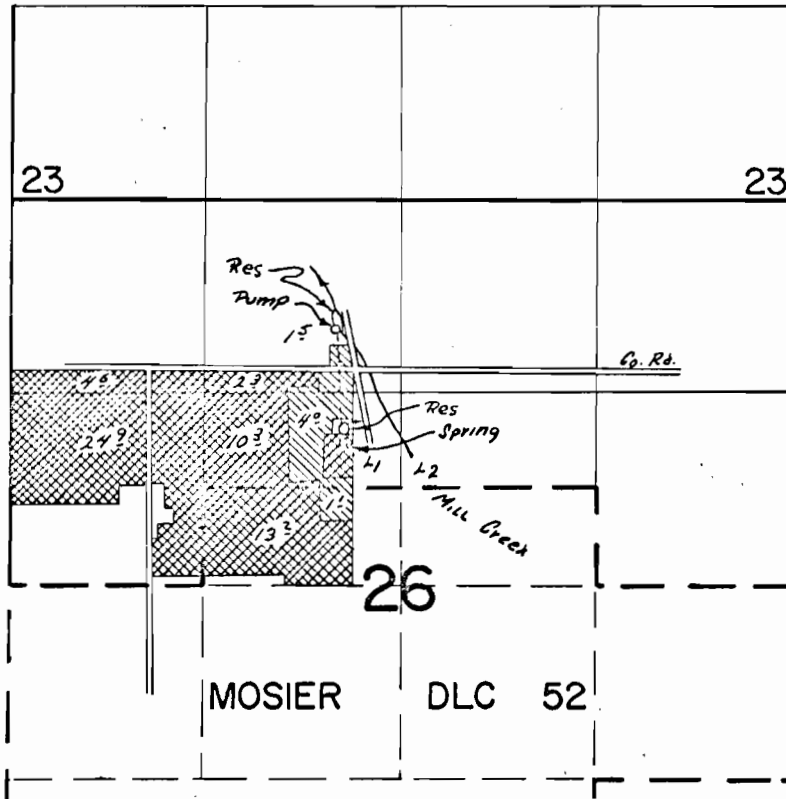

Div. Res. Loc.: Cr. & Res. 1900' N & 2200' E; Spr. Res. 1130' N & 2260' E;
Spring 1000' N & 2260' E All From N/4 Cor. Sec. 26.

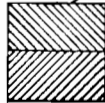

Spring & 2 Res.

Creek

FINAL PROOF SURVEY UNDER

Application No. R-46519 46374 Permit No. R-5609 34979

IN NAME OF

JOSEPH H. BIELENBERG

Surveyed June 7 1973, by R. B. Mucken