

T.6N. R.35E. W.M..

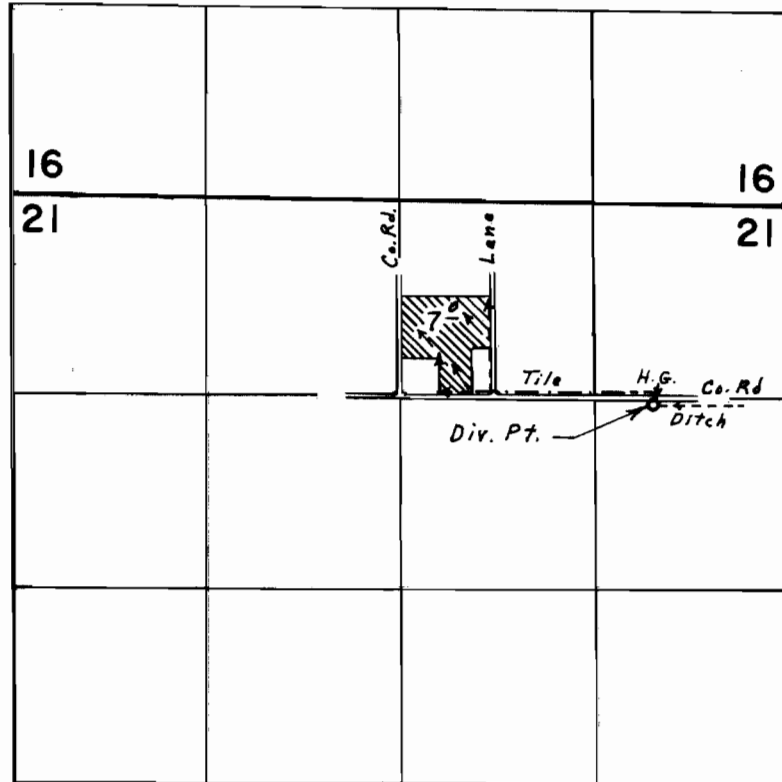

Div. Pt. loc. 1380' S. & 940' W. from N.E. Cor. Sec. 21

FINAL PROOF SURVEY
UNDER

Application No. 45192 Permit No. 33955
IN NAME OF

RICHARD M. BATES

Surveyed Aug. 8., 1973, by L. E. Gould