

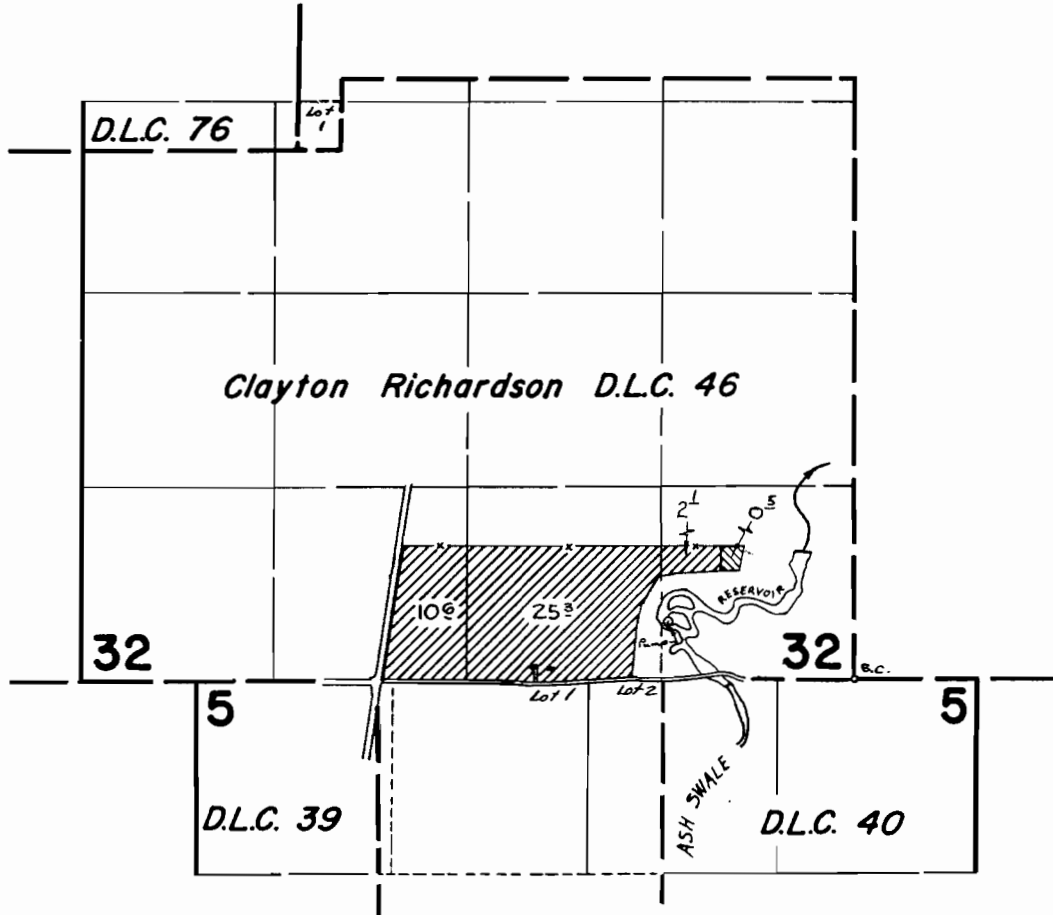



# T.5&6 S. R.4 W. W.M.



Div. Pt. Loc: 870' N. 5' 350' W. from S.E. cor. Sec. 32

## FINAL PROOF SURVEY UNDER

R-42709                      R-4966  
 42829                        32369  
 Application No. 39191      Permit No. 29144  
 IN NAME OF

 - Primary   
  - Supplemental  
 - Primary

EARL E. COMPTON

Surveyed Nov. 2, 1965, by *R. Jackson*  
 May 29, 1973                      R. G. MUCKEN