

# T. 8 S. R. 39 E. W. M.

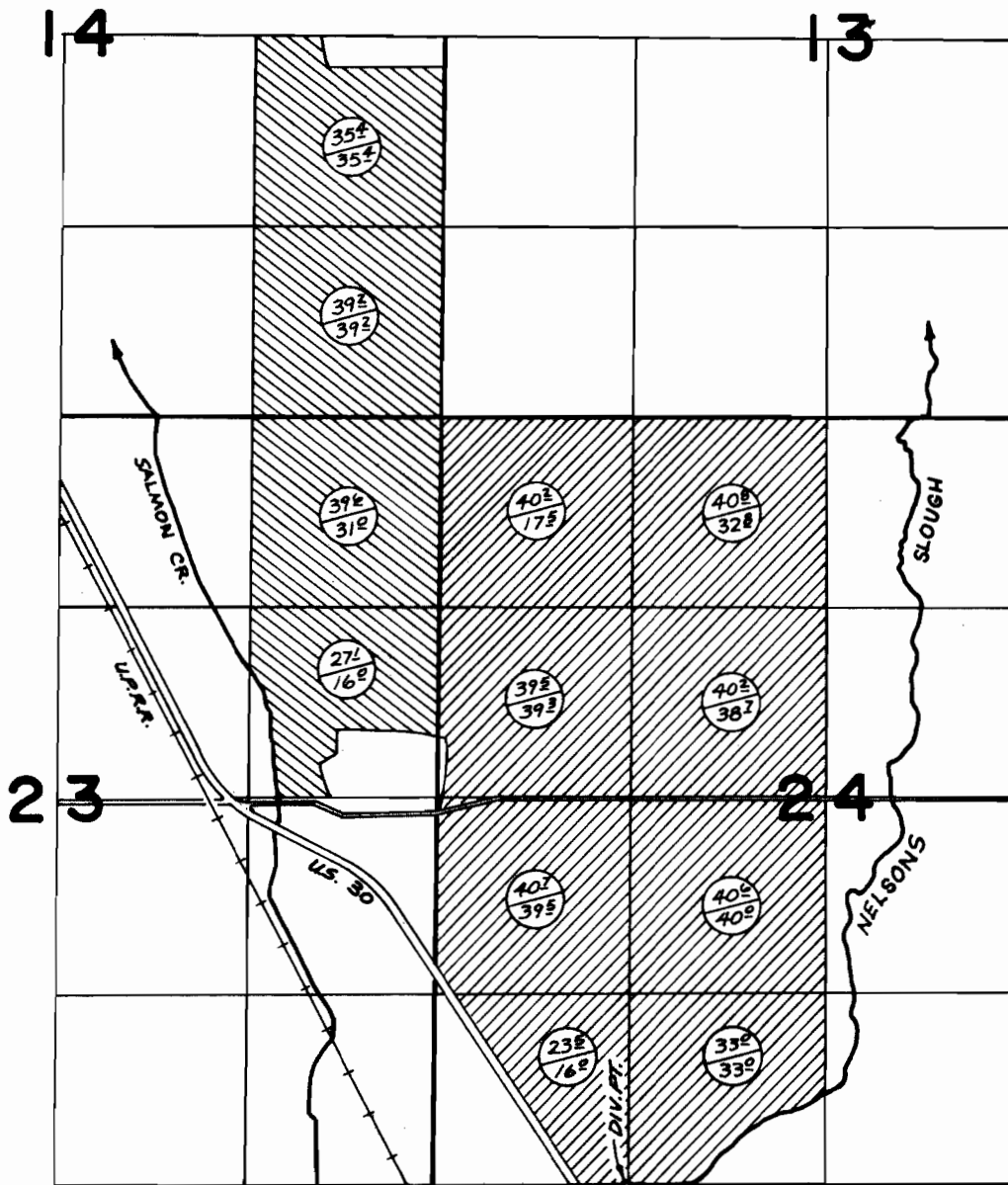

DIK. PT. - 10' N., 1340' E., FROM S.W. CORNER SECTION 24

## FINAL PROOF SURVEY

UNDER



FOUND  
ALLOWED



PRIMARY  
SUPPLEMENTAL

Application No. 48384 Permit No. 36323  
IN NAME OF

*CHANDLER HEREFORDS INC.*

Surveyed OCT. 31 1974, by L.M. TOLLY