

# T.13&14 S.R.16E.W.M.

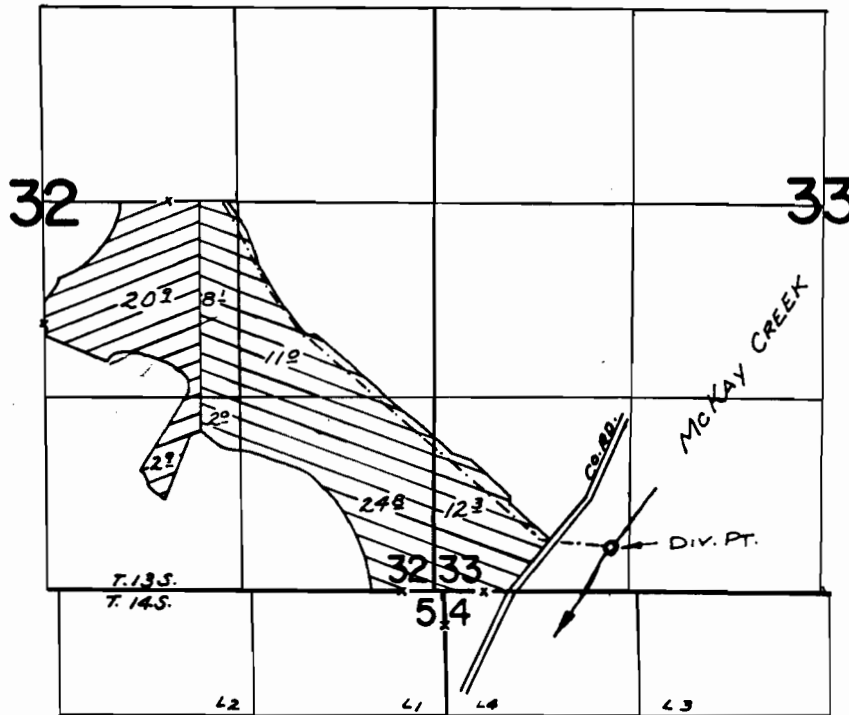

DIV. PT. LOC: 300' N & 1160' E FROM N.W. COR. SEC. 4,  
T. 14 S. R. 16 E. W. M.

 PERMIT 30070

 PERMIT 33073

## FINAL PROOF SURVEY UNDER

40318 30070  
Application No. ~~44277~~ Permit No. ~~33073~~  
IN NAME OF

FLOYD M. JONES

Surveyed JULY 10 1924, by R. MUCKEN