

T.35S. R.14W. W.M.

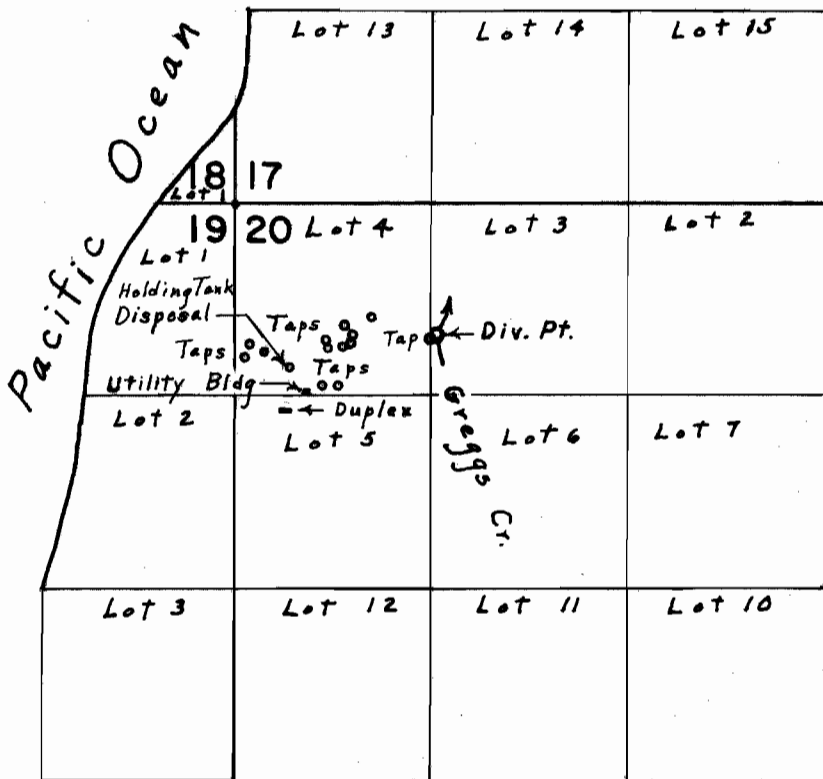

Div. Pt. located 910' S. & 1380' E. from N.W. Cor. Sec. 20

FINAL PROOF SURVEY
UNDER

Application No. 48065 Permit No. 36056
IN NAME OF
HONEY BEAR LODGE

Surveyed Aug. 23, 1974, by L. E. Gould