

T.36S. R.14W. W.M.

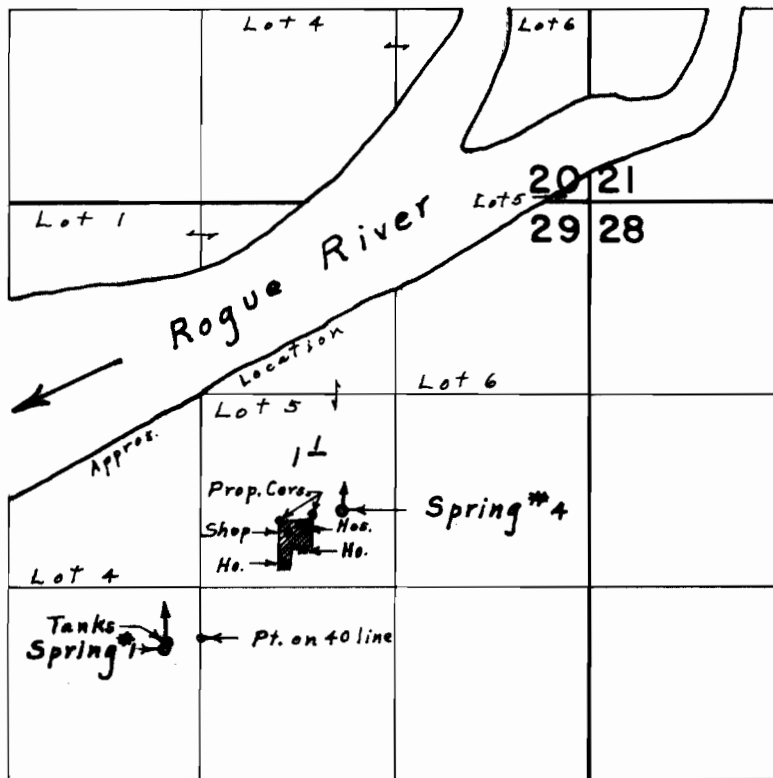

Springs located: #1, 430' S. & 230' W.; #4, 530' N. & 970' E.,
both from center of Sec. 29

FINAL PROOF SURVEY
UNDER

Application No. 42067 Permit No. 36720
IN NAME OF
KERMIT LYNCH

Surveyed Aug. 23 1974, by L. E. Gould