

T.31S. R.15W. W.M.

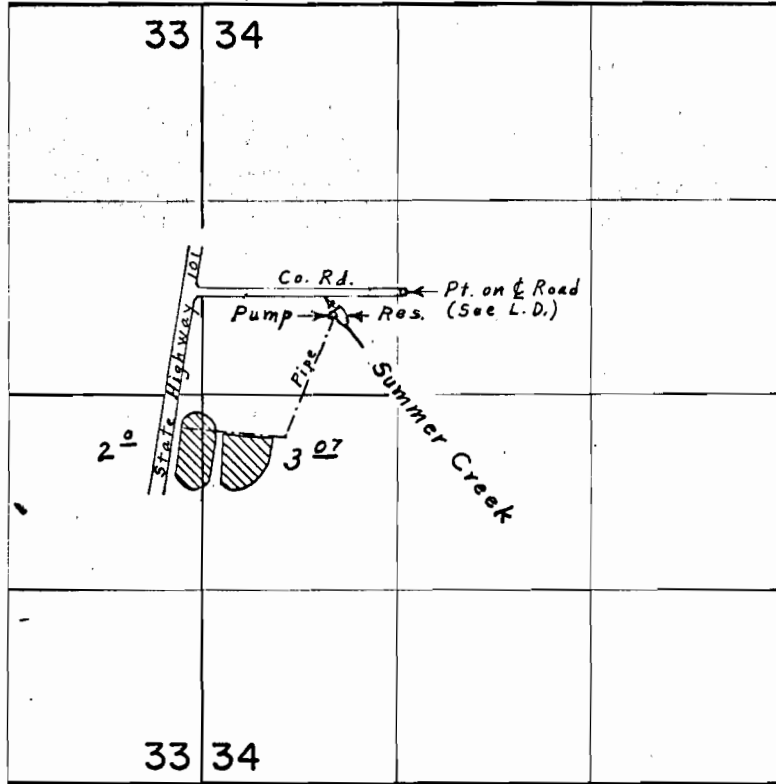

Dir Pt. Loc: 580 Ft. N. & 1740 Ft. W. from Center Sec. 34

FINAL PROOF SURVEY
UNDER

R-43351 ✓ R-5032
Application No. 43352 Permit No. 32746
IN NAME OF

PORT ORFORD LANGLOIS SCHOOL

Surveyed Aug. 6, 1974, by L. E. Gould