

G-4271  
42432

# T.2S., R.26E., W.M.

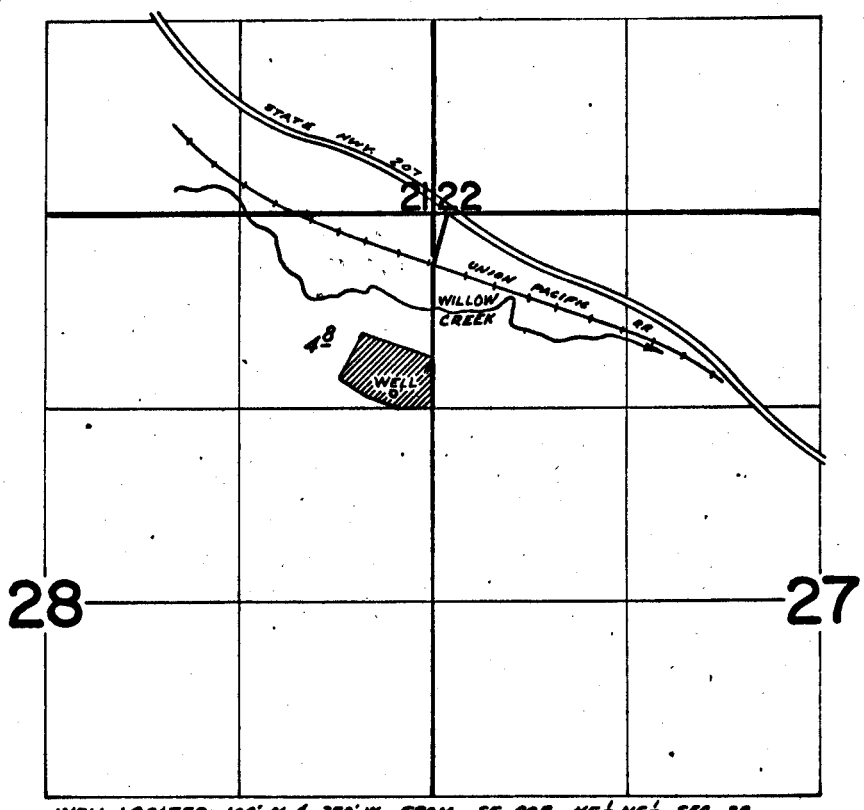

WELL LOCATED: 100' N & 270' W FROM SE COR. NE 1/4 NE 1/4 SEC. 20.

## FINAL PROOF SURVEY UNDER

Application No. G-4539 Permit No. G-4271  
IN NAME OF

BARBARA A. CUTSFORTH

Surveyed May 15 1974, by D. Norby