

G-4368  
42435

# T.2S., R.26E., W.M.

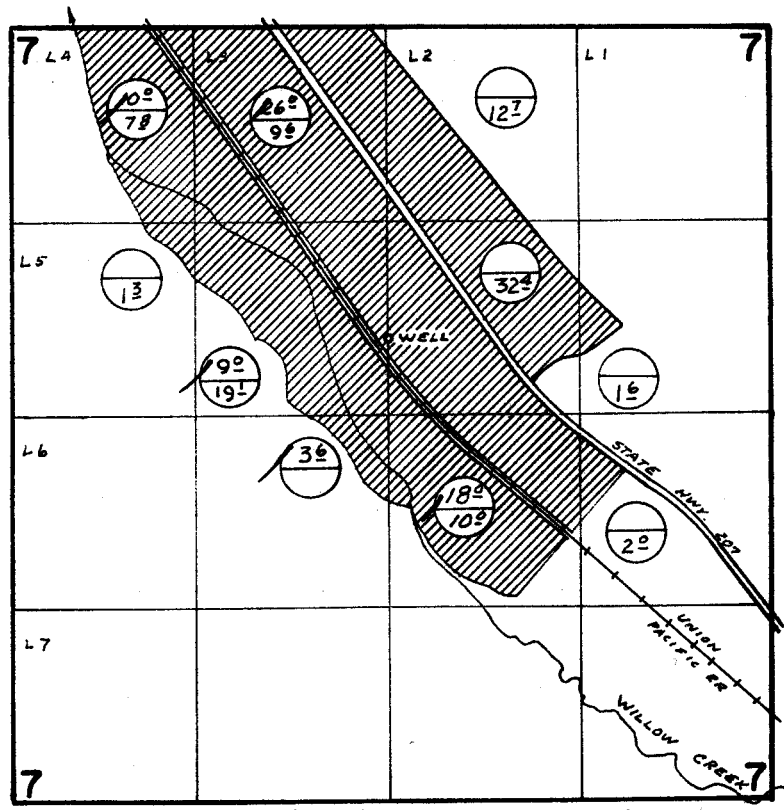

WELL LOCATED: 2110'S & 2630'W FROM NE COR SEC. 7.



## FINAL PROOF SURVEY UNDER

Application No. G-4643 Permit No. G-4368  
IN NAME OF  
EVANS RANCH

Surveyed May 16 1974, by A. Dorby