

T.2 S. R.38 E. W.M.

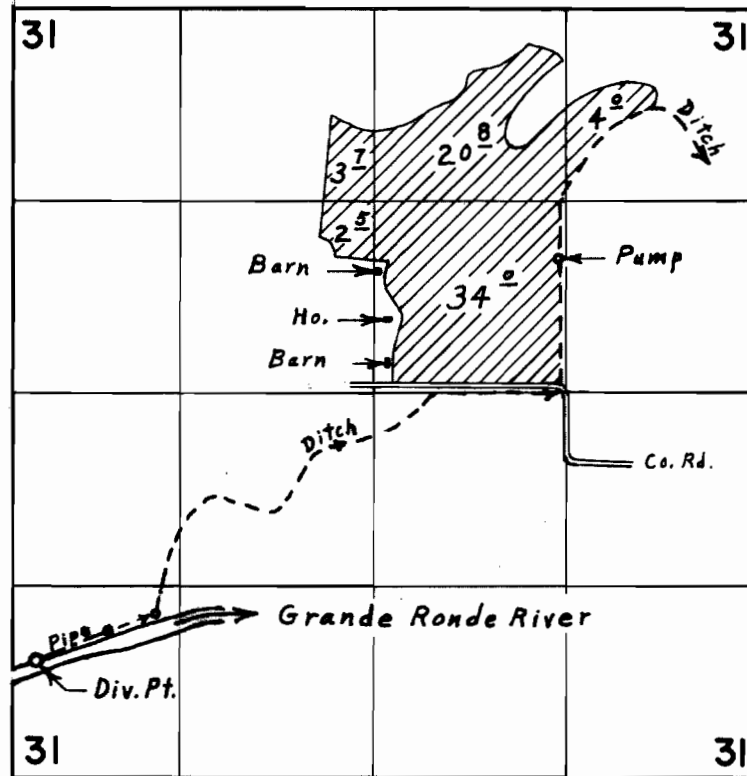

Div. Pt. located 800' N. & 160' E. from S.W. Cor. Sec. 31

FINAL PROOF SURVEY
UNDER

Application No. 48434 Permit No. 36357
IN NAME OF

HELEN McCLUNE

Surveyed Sept. 19, 1974, by L. E. Gould