

T.2N. R.12E. W.M.

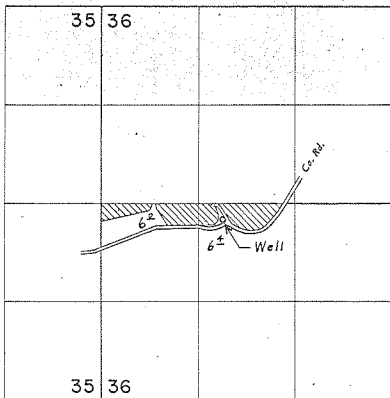

Well located 220' S. & 1670' E. from W. $\frac{1}{4}$ Cor. Sec. 36

FINAL PROOF SURVEY
UNDER

Application No. G-3961. Permit No. G-3715
IN NAME OF

DALE SLAUGHTER

Surveyed April 23, 1974, by Dave Norby.