

T.1S.R.13E.W.M.

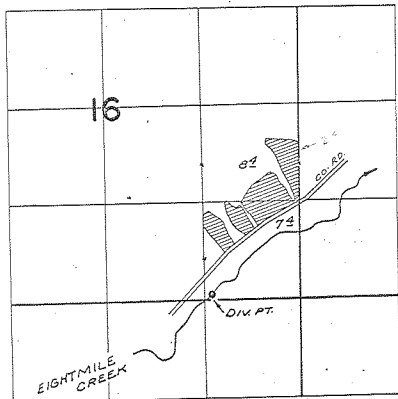

DIV. PT. LOC: 90' N. 61200' W. FROM S.E. COR. SEC. 16

FINAL PROOF SURVEY
UNDER

Application No. 44557 Permit No. 33350
IN NAME OF

HARRY V. E. DOROTHY DARNIELLE

Surveyed APR. 23 1974, by D. NORBY