

# T.8 & 9 S. R.25 E. W.M.

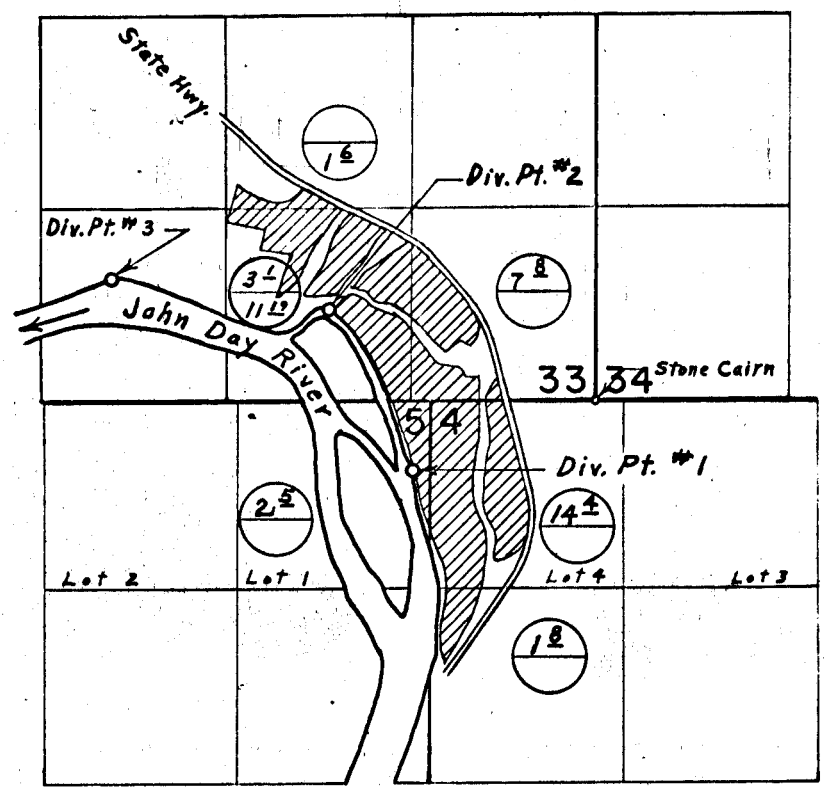

Div. Pts. located: #1- 480' S. & 1250' W.; #2- 630' N. & 1020' W.;  
 #3- 840' N. & 3300' W.; all from S. E. Corner Section 33

Primary   
 Supplemental 

## FINAL PROOF SURVEY UNDER

Application No. 38544... Permit No. 28678...  
 IN NAME OF C. 42452

**ESTATE OF CLARENCE WARREN**

Surveyed June 4, 1974., by L. E. Gould