

T.6 S. R.3 W. W.M.

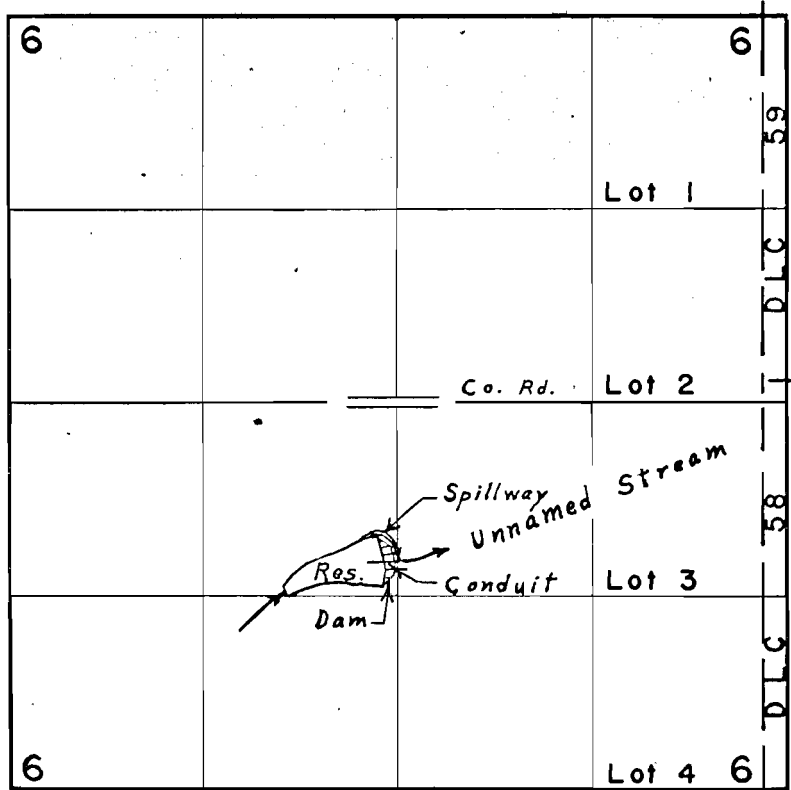

Div. Pt. located 1000' S. & 80' W. from Center Sec. 6

**FINAL PROOF SURVEY**  
UNDER

R-37830  
37831  
R-40395

R-3202  
28551  
R-4516

Application No. 40397 Permit No. 30122

IN NAME OF

**HENRY & ALBERT SCHINDLER**

Surveyed Sept. 5, 1973, by L. E. Gould