

T.6 S. R.3 W. W.M.

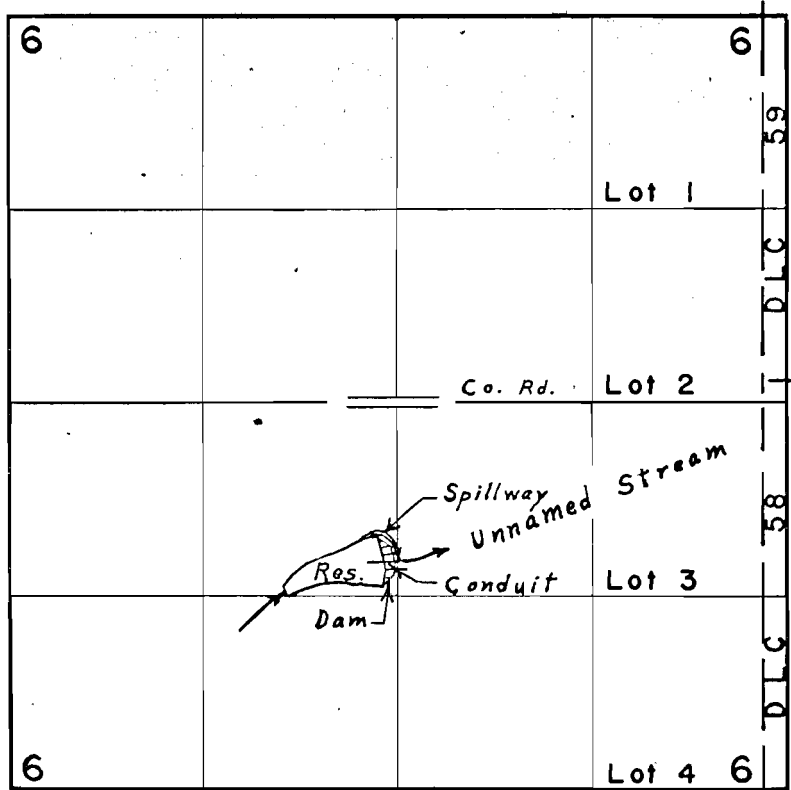

Div. Pt. located 1000' S. & 80' W. from Center Sec. 6

FINAL PROOF SURVEY
UNDER

R-37830
37831
R-40395

R-3202
28551
R-4516

Application No. 40397 Permit No. 30122

IN NAME OF

HENRY & ALBERT SCHINDLER

Surveyed Sept. 5, 1973, by L. E. Gould